



Guided Plug Straight Through Control Valve-Summary



ARI-STEVI® 470 / 471 (DN15-150)
 Control valve - straight through
 with screwed seat ring, shaftguided plug and blow-out protected stem

With pneumatic and electric actuators

ARI-STEVI® 470 / 471

Pneumatic actuator

ARI-DP 32 - 35

- Reversible pneumatic actuator
- Actuator with rolling diaphragm
- Air supply pressure max. 6 bar
- Stem protection by bellow
- Maintenance-free O-ring sealing
- Assembly of additional devices acc. to DIN IEC 60534-6

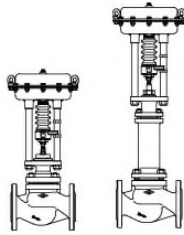

Page 4

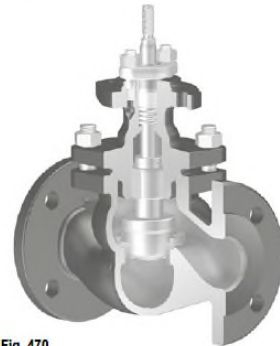

Fig. 470

ARI-STEVI® 470 / 471

Electric actuator

ARI-PREMIO 2,2 - 25 kN

ARI-PREMIO-Plus 2G 2,2 - 25kN

- Enclosure IP 65
- 2 torque switches
- Handwheel
- Additional devices available, e.g. potentiometer

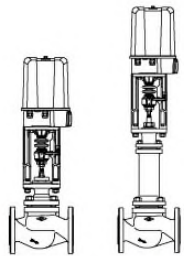

Page 14

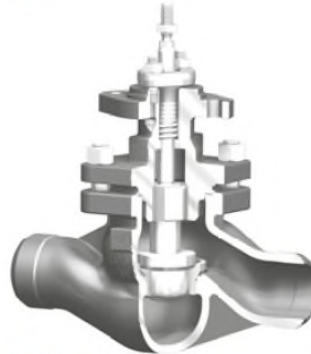

Fig. 470...4

ARI-STEVI® 470 / 471

Electric actuator

with fail-safe function

ARI-PREMIO-Plus 2G 9 kN

- Enclosure IP 65
- 2 torque switches
- Handwheel
- Additional devices available, e.g. potentiometer

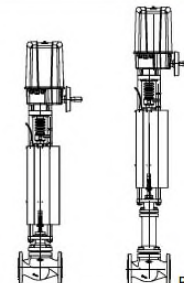

Page 16

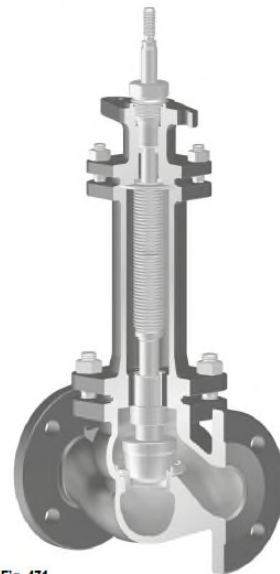

Fig. 471

ARI-STEVI® 470 / 471

Electric actuator

AUMA SAR 07.2 - 14.6

- Enclosure IP 67
- 2 torque switches
- 2 travel switches
- Handwheel
- Overheating protection for motor as standard
- Additional devices available, e.g. potentiometer
- Explosion proof version available

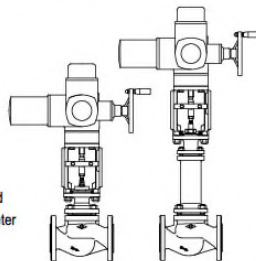

Page 18

For further details please contact your local VCS office ensuring you have all the system requirements or if wishing a refurbishment or direct replacement the appropriate model number etc.