



VALVE AND FLOW CONTROL SPECIALISTS
SERVICE AND RELIABILITY

Flange dimension guide



Brisbane Sydney Melbourne Darwin
VALVE AND FLOW CONTROL SPECIALISTS PTY LTD
E-mail sales@valveandflowcontrolspecialists.com

NOTES:

There maybe some rounding or conversion deviations but these should not exceed+- 1.5mm
The information in this guide should not be substitute for detailed advice or a basis for decision making,
Whilst every care has been made in this compilation of these tables no guarantee is given norliability
accepted for their accuracy. For precise data, particularly on flange thickness, refer to the relevant standard.
This flange information does not necessarily apply to valves and other pipeline equipment which are often
designed to accommodate multiple flange standards. Consult the relevant Manufacturers data for their
relevant products.

How to Measure Flanges & Gaskets

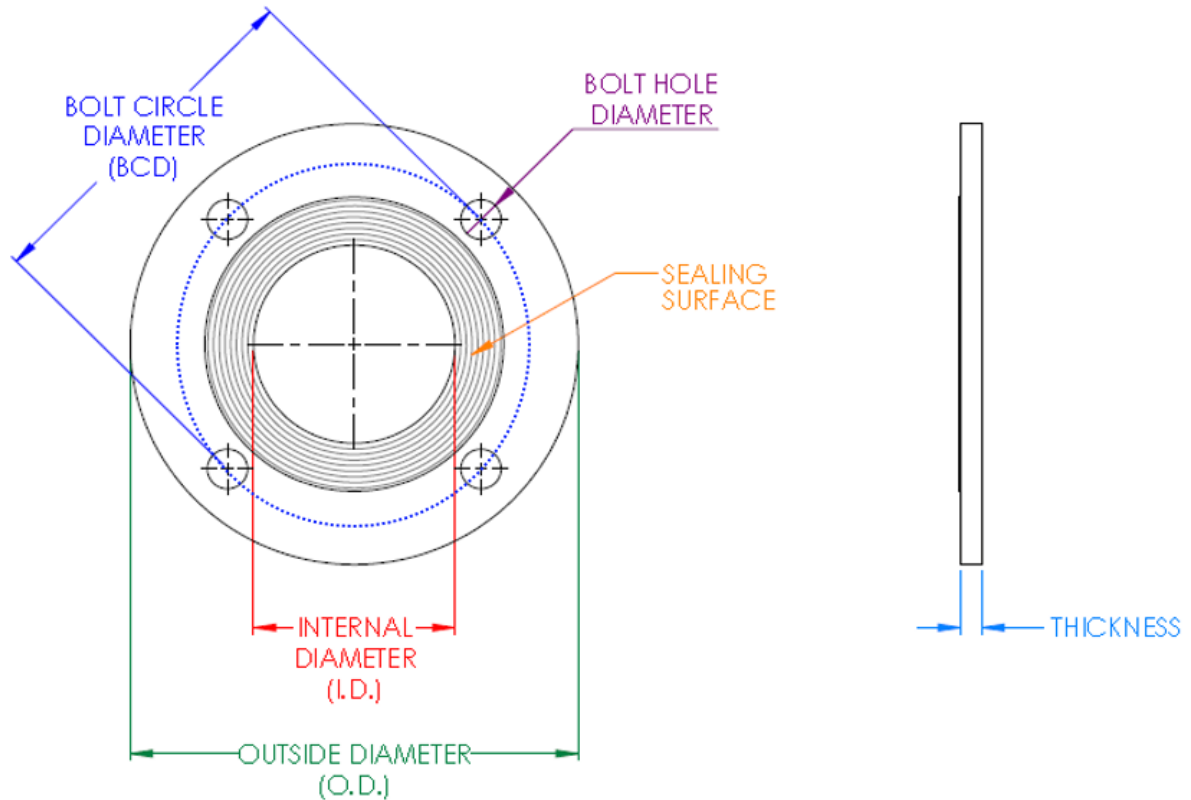

The measuring principles apply to both flanges and gaskets.

*Above is a drawing of a Flange.

The **Bolt Circle** is the measurement (diameter) of an imaginary circle passing through the centers of all the bolts in a round pattern. This is represented by the **Blue Dashed Circle** in the drawing. To measure such circle measure from the center of one bolt directly across to the center of the other bolt.

The **Outside Diameter** is the measurement of the outside of the Flange or Gasket.

The **Inside Diameter** is the measurement of the inside of the hole of a Flange or Gasket.

The **Sealing Surface** is the area of contact the gasket is placed to seal between two flange connections.

All measurements should be made across the center of the flange or gasket.

Flange dimensions

Nominal size: 15mm

	Class / Table	Outside Diameter	Pitch Circle Diameter	No. Holes	Hole Diameter	Bolt Diameter	Minimum Flange Thickness			
							Cast Iron	Ductile Iron	Copper Alloy	Steel
AS 4087	PN14	95	67	4	14	M12	-	-	6	-
	PN16	-	-	-	-	-	-	-	-	-
	PN21	-	-	-	-	-	-	-	-	-
	PN35	-	-	-	-	-	-	-	-	-
Drilling for AS 4087 Class PN14 & PN16 is compatible with AS 2129, Table D Drilling for AS 4087 Class PN21 & PN35 is compatible with AS 2129, Table F & Table H										

AS 2129	Table A	95	67	4	14	M12	13	13	6	5
	Table D	95	67	4	14	M12	13	13	6	5
	Table E	95	67	4	14	M12	13	13	6	6
	Table F	95	67	4	14	M12	13	13	8	10
	Table H	115	83	4	18	M16	16	16	10	13

ISO 7005 (DIN)	PN6	80	55	4	11	M10	12	-	6	12
	PN10	95	65	4	14	M12	14	-	6	14
	PN16	95	65	4	14	M12	14	-	6	-
	PN20	90	60.5	4	16	M14	-	-	-	11.5
	PN25	95	65	4	14	M12	16	-	8	14
	PN40	95	65	4	14	M12	16	-	9	14
Drilling Compatible with AS/NZS 4331, BS 4504 & DIN 2533										

ANSI B16.5	150	90	60.3	4	5/8" - 15.9	1/2" - 12.7	-	-	-	11.2
	300	95	66.7	4	5/8" - 15.9	1/2" - 12.7	-	-	-	14.3
	600	95	66.7	4	5/8" - 15.9	1/2" - 12.7	-	-	-	14.3
Drilling for ANSI B16.5, Class 150 is compatible with ANSI B16.1, Class 125										

Nominal size: 20mm

Class / Table	Outside Diameter	Pitch Circle Diameter	No. Holes	Hole Diameter	Bolt Diameter	Minimum Flange Thickness			
						Cast Iron	Ductile Iron	Copper Alloy	Steel

AS 4087	PN14	100	73	4	14	M12	-	-	6	-
	PN16	-	-	-	-	-	-	-	-	-
	PN21	-	-	-	-	-	-	-	-	-
	PN35	-	-	-	-	-	-	-	-	-

Drilling for AS 4087 Class PN14 & PN16 is compatible with AS 2129, Table D

Drilling for AS 4087 Class PN21 & PN35 is compatible with AS 2129, Table F & Table H

AS 2129	Table A	100	73	4	14	M12	13	13	6	5
	Table D	100	73	4	14	M12	13	13	6	5
	Table E	100	73	4	14	M12	13	13	6	6
	Table F	100	73	4	14	M12	13	13	8	10
	Table G	115	83	4	18	M16	16	16	10	13

ISO 7005 (DIN)	PN6	90	65	4	11	M10	14	-	6	14
	PN10	105	75	4	14	M12	16	-	6	16
	PN16	105	75	4	14	M12	16	-	6	-
	PN20	100	70	4	16	M14	-	-	8	13
	PN25	105	75	4	14	M12	18	-	8	16
	PN40	105	75	4	14	M12	18	-	9	16

Drilling Compatible with AS/NZS 4331, BS 4504 & DIN 2533

ANSI B16.5	150	100	69.9	4	5/8" - 15.9	1/2" - 12.7	-	-	-	12.7
	300	115	82.6	4	3/4" - 19.1	5/8" - 15.9	-	-	-	15.9
	600	115	82.6	4	3/4" - 19.1	5/8" - 15.9	-	-	-	15.9

Drilling for ANSI B16.5, Class 150 is compatible with ANSI B16.1, Class 125

Flange dimensions

Nominal size: 25mm

	Class / Table	Outside Diameter	Pitch Circle Diameter	No. Holes	Hole Diameter	Bolt Diameter	Minimum Flange Thickness			
							Cast Iron	Ductile Iron	Copper Alloy	Steel
AS 4087	PN14	115	83	4	14	M12	-	-	8	-
	PN16	-	-	-	-	-	-	-	-	-
	PN21	-	-	-	-	-	-	-	-	-
	PN35	-	-	-	-	-	-	-	-	-
Drilling for AS 4087 Class PN14 & PN16 is compatible with AS 2129, Table D Drilling for AS 4087 Class PN21 & PN35 is compatible with AS 2129, Table F & Table H										

AS 2129	Table A	115	83	4	14	M12	13	13	8	5
	Table D	115	83	4	14	M12	13	13	8	5
	Table E	115	83	4	14	M12	13	13	8	7
	Table F	120	87	4	18	M16	13	13	10	10
	Table H	120	87	4	18	M16	19	19	11	14

ISO 7005 (DIN)	PN6	100	75	4	11	M10	14	-	8	14
	PN10	115	85	4	14	M12	16	-	8	16
	PN16	115	85	4	14	M12	16	-	8	-
	PN20	110	79.5	4	16	M14	11	11	9	11.5
	PN25	115	85	4	14	M12	18	-	9	16
	PN40	115	85	4	14	M12	18	-	11	16
Drilling Compatible with AS/NZS 4331, BS 4504 & DIN 2533										

ANSI B16.5	150	110	79.4	4	5/8" - 15.9	1/2" - 12.7	-	-	-	14.3
	300	125	88.9	4	3/4" - 19.1	5/8" - 15.9	-	-	-	17.5
	600	125	88.9	4	3/4" - 19.1	5/8" - 15.9	-	-	-	17.5
Drilling for ANSI B16.5, Class 150 is compatible with ANSI B16.1, Class 125										

Nominal size: 32mm

Class / Table	Outside Diameter	Pitch Circle Diameter	No. Holes	Hole Diameter	Bolt Diameter	Minimum Flange Thickness				
						Cast Iron	Ductile Iron	Copper Alloy	Steel	
AS 4087	PN14	120	87	4	14	M12	-	-	8	-
	PN16	-	-	-	-	-	-	-	-	-
	PN21	-	-	-	-	-	-	-	-	-
	PN35	-	-	-	-	-	-	-	-	-

Drilling for AS 4087 Class PN14 & PN16 is compatible with AS 2129, Table D

Drilling for AS 4087 Class PN21 & PN35 is compatible with AS 2129, Table F & Table H

AS 2129	Table A	120	87	4	14	M12	16	16	8	6
	Table D	120	87	4	14	M12	16	16	8	6
	Table E	120	87	4	14	M12	16	16	8	8
	Table F	135	98	4	18	M16	16	16	10	13
	Table H	135	98	4	18	M16	22	22	11	17

ISO 7005 (DIN)	PN6	120	90	4	14	M12	16	-	8	16
	PN10	140	100	4	18	M16	18	-	8	18
	PN16	140	100	4	18	M16	18	-	8	-
	PN20	120	89	4	16	M14	13	13	10	13
	PN25	140	100	4	18	M16	20	-	9	18
	PN40	140	100	4	18	M16	20	-	11	18

Drilling Compatible with AS/NZS 4331, BS 4504 & DIN 2533

ANSI B16.5	150	115	88.9	4	5/8" - 15.9	1/2" - 12.7	-	-	-	15.9
	300	135	98.4	4	3/4" - 19.1	5/8" - 15.9	-	-	-	19.1
	600	135	98.4	4	3/4" - 19.1	5/8" - 15.9	-	-	-	20.7

Drilling for ANSI B16.5, Class 150 is compatible with ANSI B16.1, Class 125

Flange dimensions

Nominal size: 40mm

	Class / Table	Outside Diameter	Pitch Circle Diameter	No. Holes	Hole Diameter	Bolt Diameter	Minimum Flange Thickness			
							Cast Iron	Ductile Iron	Copper Alloy	Steel
AS 4087	PN14	135	98	4	14	M12	-	-	10	-
	PN16	-	-	-	-	-	-	-	-	-
	PN21	-	-	-	-	-	-	-	-	-
	PN35	-	-	-	-	-	-	-	-	-
Drilling for AS 4087 Class PN14 & PN16 is compatible with AS 2129, Table D Drilling for AS 4087 Class PN21 & PN35 is compatible with AS 2129, Table F & Table H										

AS 2129	Table A	135	98	4	14	M12	16	16	10	6
	Table D	135	98	4	14	M12	16	16	10	6
	Table E	135	98	4	14	M12	16	16	10	9
	Table F	140	105	4	18	M16	16	16	11	13
	Table H	140	105	4	18	M16	22	22	13	17

ISO 7005 (DIN)	PN6	130	100	4	14	M12	16	-	9	16
	PN10	150	110	4	18	M16	18	19	9	18
	PN16	150	110	4	18	M16	18	19	9	-
	PN20	130	98.5	4	16	M14	14.5	14.5	11	14.5
	PN25	150	110	4	18	M16	20	19	11	18
	PN40	150	110	4	18	M16	20	19	13	18
Drilling Compatible with AS/NZS 4331, BS 4504 & DIN 2533										

ANSI B16.5	150	125	98.4	4	5/8" - 15.9	1/2" - 12.7	-	-	-	17.5
	300	155	114.3	4	7/8" - 22.2	3/4" - 19.1	-	-	-	20.7
	600	155	114.3	4	7/8" - 22.2	3/4" - 19.1	-	-	-	22.3
Drilling for ANSI B16.5, Class 150 is compatible with ANSI B16.1, Class 125										

Nominal size: 50mm

Class / Table	Outside Diameter	Pitch Circle Diameter	No. Holes	Hole Diameter	Bolt Diameter	Minimum Flange Thickness				
						Cast Iron	Ductile Iron	Copper Alloy	Steel	
AS 4087	PN14	150	114	4	18	M16	-	-	10	-
	PN16	150	114	4	18	M16	-	-	-	11
	PN21	165	127	4	18	M16	-	-	-	15
	PN35	165	127	4	18	M16	-	-	-	19

Drilling for AS 4087 Class PN14 & PN16 is compatible with AS 2129, Table D

Drilling for AS 4087 Class PN21 & PN35 is compatible with AS 2129, Table F & Table H

AS 2129	Table A	150	114	4	18	M16	16	16	10	8
	Table D	150	114	4	18	M16	17	17	10	8
	Table E	150	114	4	18	M16	19	19	10	10
	Table F	165	127	4	18	M16	19	19	11	16
	Table H	165	127	4	18	M16	25	25	13	19

ISO 7005 (DIN)	PN6	140	110	4	14	M12	16	-	11	16
	PN10	165	125	4	18	M16	20	19	11	20
	PN16	165	125	4	18	M16	20	19	11	-
	PN20	150*	120.5	4	18	M16	16	16	13	16
	PN25	165	125	4	18	M16	22	19	11	20
	PN40	165	125	4	18	M16	22	19	13	20

Drilling Compatible with AS/NZS 4331, BS 4504 & DIN 2533

*When made from cast or ductile iron, this flange features an outside diameter of 155mm.

ANSI B16.5	150	150	120.7	4	3/4" - 19.1	5/8" - 15.9	-	-	-	19.1
	300	165	127	8	3/4" - 19.1	5/8" - 15.9	-	-	-	22.3
	600	165	127	8	3/4" - 19.1	5/8" - 15.9	-	-	-	25.4

Drilling for ANSI B16.5, Class 150 is compatible with ANSI B16.1, Class 125

Flange dimensions

Nominal size: 65mm

	Class / Table	Outside Diameter	Pitch Circle Diameter	No. Holes	Hole Diameter	Bolt Diameter	Minimum Flange Thickness			
							Cast Iron	Ductile Iron	Copper Alloy	Steel
AS 4087	PN14	165	127	4	18	M16	-	-	11	-
	PN16	165	127	4	18	M16	-	-	-	11
	PN21	185	146	8	18	M16	-	-	-	15
	PN35	185	146	8	18	M16	-	-	-	19

Drilling for AS 4087 Class PN14 & PN16 is compatible with AS 2129, Table D
 Drilling for AS 4087 Class PN21 & PN35 is compatible with AS 2129, Table F & Table H

AS 2129	Table A	165	127	4	18	M16	17	17	11	8
	Table D	165	127	4	18	M16	17	17	11	8
	Table E	165	127	4	18	M16	19	19	11	10
	Table F	185	146	8	18	M16	19	19	13	16
	Table H	185	146	8	18	M16	25	25	14	19

ISO 7005 (DIN)	PN6	160	130	4	14	M12	16	-	12	16
	PN10	185	145	4*	18	M16	20	19	13	20
	PN16	185	145	4*	18	M16	20	19	13	20
	PN20	180	139.5	4	18	M16	17.5	17.5	14	17.5
	PN25	185	145	8	18	M16	24	19	13	22
	PN40	185	145	8	18	M16	24	19	14	22

Drilling Compatible with AS/NZS 4331, BS 4504 & DIN 2533
 *When made from steel, these flanges feature 8 holes.

ANSI B16.5	150	180	139.7	4	3/4" - 19.1	5/8" - 15.9	-	-	-	22.3
	300	190	149.2	8	7/8" - 22.2	3/4" - 19.1	-	-	-	25.4
	600	190	149.2	8	7/8" - 22.2	3/4" - 19.1	-	-	-	28.6

Drilling for ANSI B16.5, Class 150 is compatible with ANSI B16.1, Class 125

Nominal size: 80mm

Class / Table	Outside Diameter	Pitch Circle Diameter	No. Holes	Hole Diameter	Bolt Diameter	Minimum Flange Thickness			
						Cast Iron	Ductile Iron	Copper Alloy	Steel

AS 4087	PN14	185	146	4	18	M16	19	-	13	-
	PN16	185	146	4	18	M16	-	18	-	11
	PN21	205	165	8	18	M16	19	-	-	15
	PN35	205	165	8	18	M16	29	22	-	24

Drilling for AS 4087 Class PN14 & PN16 is compatible with AS 2129, Table D

Drilling for AS 4087 Class PN21 & PN35 is compatible with AS 2129, Table F & Table H

AS 2129	Table A	185	146	4	18	M16	17	17	13	10
	Table D	185	146	4	18	M16	19	19	13	10
	Table E	185	146	4	18	M16	19	19	13	11
	Table F	205	165	8	18	M16	19	19	14	16
	Table H	205	165	8	18	M16	29	29	16	22

ISO 7005 (DIN)	PN6	190	150	4	18	M16	18	-	13	18
	PN10	200	160	8	18	M16	22	19	13	20
	PN16	200	160	8	18	M16	22	19	13	20
	PN20	190	152.5	4	18	M16	19	19	16	19.5
	PN25	200	160	8	18	M16	26	19	14	24
	PN40	200	160	8	18	M16	26	19	16	24

Drilling Compatible with AS/NZS 4331, BS 4504 & DIN 2533

ANSI B16.5	150	190	152.4	4	3/4" - 19.1	5/8" - 15.9	-	-	-	23.9
	300	210	168.3	8	7/8" - 22.2	3/4" - 19.1	-	-	-	28.6
	600	210	168.3	8	7/8" - 22.2	3/4" - 19.1	-	-	-	31.8

Drilling for ANSI B16.5, Class 150 is compatible with ANSI B16.1, Class 125

Flange dimensions

Nominal size: 100mm

	Class / Table	Outside Diameter	Pitch Circle Diameter	No. Holes	Hole Diameter	Bolt Diameter	Minimum Flange Thickness			
							Cast Iron	Ductile Iron	Copper Alloy	Steel
AS 4087	PN14	215	178	4	18	M16	22	-	22	-
	PN16	215	178	4	18	M16	-	20	-	13
	PN21	230	191	8	18	M16	22	-	-	19
	PN35	230	191	8	18	M16	32	22	-	24
Drilling for AS 4087 Class PN14 & PN16 is compatible with AS 2129, Table D Drilling for AS 4087 Class PN21 & PN35 is compatible with AS 2129, Table F & Table H										

AS 2129	Table A	215	178	4	18	M16	19	19	16	10
	Table D	215	178	4	18	M16	19	19	16	10
	Table E	215	178	8	18	M16	22	22	16	13
	Table F	230	191	8	18	M16	22	22	17	19
	Table H	230	191	8	18	M16	32	32	19	25

ISO 7005 (DIN)	PN6	210	170	4	18	M16	18	-	14	18
	PN10	220	180	8	18	M16	24	19	16	22
	PN16	220	180	8	18	M16	24	19	16	22
	PN20	230	190.5	8	18	M16	24	24	17	24
	PN25	235	190	8	22	M20	28	19	17	24
	PN40	235	190	8	22	M20	28	19	19	24
Drilling Compatible with AS/NZS 4331, BS 4504 & DIN 2533										

ANSI B16.5	150	230	190.5	8	3/4" - 19.1	5/8" - 15.9	-	-	-	23.9
	300	255	200	8	7/8" - 22.2	3/4" - 19.1	-	-	-	31.8
	600	275	215.9	8	1" - 25.4	7/8" - 22.2	-	-	-	38.1
Drilling for ANSI B16.5, Class 150 is compatible with ANSI B16.1, Class 125										

Nominal size: 125mm

Class / Table	Outside Diameter	Pitch Circle Diameter	No. Holes	Hole Diameter	Bolt Diameter	Minimum Flange Thickness			
						Cast Iron	Ductile Iron	Copper Alloy	Steel

AS 4087	PN14	280	235	8	18	M16	-	-	22	-
	PN16	-	-	-	-	-	-	-	-	-
	PN21	-	-	-	-	-	-	-	-	-
	PN35	-	-	-	-	-	-	-	-	-

Drilling for AS 4087 Class PN14 & PN16 is compatible with AS 2129, Table D

Drilling for AS 4087 Class PN21 & PN35 is compatible with AS 2129, Table F & Table H

AS 2129	Table A	255	210	4	18	M16	19	19	17	13
	Table D	255	210	8	18	M16	21	21	17	13
	Table E	255	210	8	18	M16	22	22	17	14
	Table F	280	235	8	22	M20	25	25	19	22
	Table H	280	235	8	22	M20	35	35	22	29

ISO 7005 (DIN)	PN6	240	200	8	18	M16	20	-	14	18
	PN10	250	210	8	18	M16	26	19	18	22
	PN16	250	210	8	18	M16	26	19	18	22
	PN20	255	216	8	22	M20	24	24	19	24
	PN25	270	220	8	26	M24	30	19	24	26
	PN40	270	220	8	26	M24	30	23.5	24	26

Drilling Compatible with AS/NZS 4331, BS 4504 & DIN 2533

ANSI B16.5	150	255	215.9	8	7/8" - 22.2	3/4" - 19.1	-	-	-	23.9
	300	280	235	8	7/8" - 22.2	3/4" - 19.1	-	-	-	35
	600	330	266.7	8	1 1/8" - 28.6	1" - 25.4	-	-	-	44.5

Drilling for ANSI B16.5, Class 150 is compatible with ANSI B16.1, Class 125mm

Flange dimensions

Nominal size: 150mm

	Class / Table	Outside Diameter	Pitch Circle Diameter	No. Holes	Hole Diameter	Bolt Diameter	Minimum Flange Thickness			
							Cast Iron	Ductile Iron	Copper Alloy	Steel
AS 4087	PN14	280	235	8	18	M16	22	-	22	-
	PN16	280	235	8	18	M16	-	23	-	13
	PN21	305	260	12	22	M20	25	-	-	24
	PN35	305	260	12	22	M20	35	27	-	31

Drilling for AS 4087 Class PN14 & PN16 is compatible with AS 2129, Table D
 Drilling for AS 4087 Class PN21 & PN35 is compatible with AS 2129, Table F & Table H

AS 2129	Table A	280	235	4	18	M16	21	21	17	13
	Table D	280	235	8	18	M16	21	21	17	13
	Table E	280	235	8	22	M20	22	22	17	17
	Table F	305	260	12	22	M20	25	25	22	22
	Table H	305	260	12	22	M20	35	35	25	29

ISO 7005 (DIN)	PN6	265	225	8	18	M16	20	-	14	20
	PN10	285	240	8	22	M20	26	19	18	24
	PN16	285	240	8	22	M20	26	19	18	24
	PN20	280	241.5	8	22	M20	25.5	25.5	21	25.5
	PN25	300	250	8	26	M24	34	20	24	28
	PN40	300	250	8	26	M24	34	26	24	28

Drilling Compatible with AS/NZS 4331, BS 4504 & DIN 2533

ANSI B16.5	150	280	241.3	8	7/8" - 22.2	3/4" - 19.1	-	-	-	25.4
	300	320	269.9	12	7/8" - 22.2	3/4" - 19.1	-	-	-	36.6
	600	355	292.1	12	1 1/8" - 28.6	1" - 25.4	-	-	-	47.7

Drilling for ANSI B16.5, Class 150 is compatible with ANSI B16.1, Class 125

Nominal size: 200mm

Class / Table	Outside Diameter	Pitch Circle Diameter	No. Holes	Hole Diameter	Bolt Diameter	Minimum Flange Thickness				
						Cast Iron	Ductile Iron	Copper Alloy	Steel	
AS 4087	PN14	335	292	8	18	M16	25	-	-	-
	PN16	335	292	8	18	M16	-	23	-	19
	PN21	370	324	12	22	M20	29	-	-	24
	PN35	370	324	12	22	M20	41	31	-	31

Drilling for AS 4087 Class PN14 & PN16 is compatible with AS 2129, Table D

Drilling for AS 4087 Class PN21 & PN35 is compatible with AS 2129, Table F & Table H

AS 2129	Table A	335	292	8	18	M16	22	22	19	13
	Table D	335	292	8	18	M16	22	22	19	13
	Table E	335	292	8	22	M20	25	25	19	19
	Table F	370	324	12	22	M20	29	29	25	25
	Table H	370	324	12	22	M20	38	38	32	32

ISO 7005 (DIN)	PN6	320	280	8	18	M16	22	-	18	22
	PN10	340	295	8	22	M20	26	20	20	24
	PN16	340	295	12	22	M20	30	20	22	24
	PN20	345	298.5	8	22	M20	28.5	28.5	24	29
	PN25	360	310	12	26	M24	34	22	26	30
	PN40	375	320	12	29.5	M27	40	30	30	34

Drilling Compatible with AS/NZS 4331, BS 4504 & DIN 2533

ANSI B16.5	150	345	298.5	8	$\frac{7}{8}$ " - 22.2	$\frac{3}{4}$ " - 19.1	-	-	-	28.6
	300	380	330.2	12	1" - 25.4	$\frac{7}{8}$ " - 22.2	-	-	-	41.3
	600	420	349.2	12	1 $\frac{1}{4}$ " - 31.8	1 $\frac{1}{8}$ " - 28.6	-	-	-	55.6

Drilling for ANSI B16.5, Class 150 is compatible with ANSI B16.1, Class 125m

Flange dimensions

Nominal size: 225mm

Class / Table	Outside Diameter	Pitch Circle Diameter	No. Holes	Hole Diameter	Bolt Diameter	Minimum Flange Thickness				
						Cast Iron	Ductile Iron	Copper Alloy	Steel	
AS 4087	PN14	370	324	8	18	M16	25	-	-	-
	PN16	370	324	8	18	M16	-	24	-	19
	PN21	405	356	12	26	M24	29	-	-	30
	PN35	405	356	12	26	M24	41	34	-	38

Drilling for AS 4087 Class PN14 & PN16 is compatible with AS 2129, Table D
 Drilling for AS 4087 Class PN21 & PN35 is compatible with AS 2129, Table F & Table H

AS 2129	Table A	-	-	-	-	-	-	-	-	-
	Table D	-	-	-	-	-	-	-	-	-
	Table E	-	-	-	-	-	-	-	-	-
	Table F	-	-	-	-	-	-	-	-	-
	Table H	-	-	-	-	-	-	-	-	-

ISO 7005 (DIN)	PN6	-	-	-	-	-	-	-	-	-
	PN10	-	-	-	-	-	-	-	-	-
	PN16	-	-	-	-	-	-	-	-	-
	PN20	-	-	-	-	-	-	-	-	-
	PN25	-	-	-	-	-	-	-	-	-
	PN40	-	-	-	-	-	-	-	-	-

Drilling Compatible with AS/NZS 4331, BS 4504 & DIN 2533

ANSI B16.5	125/150	-	-	-	-	-	-	-	-	-
	300	-	-	-	-	-	-	-	-	-
	600	-	-	-	-	-	-	-	-	-

Nominal size: 250mm

Class / Table	Outside Diameter	Pitch Circle Diameter	No. Holes	Hole Diameter	Bolt Diameter	Minimum Flange Thickness				
						Cast Iron	Ductile Iron	Copper Alloy	Steel	
AS 4087	PN14	405	356	8	22	M20	25	-	-	-
	PN16	405	356	8	22	M20	-	24	-	19
	PN21	430	381	12	26	M24	32	-	-	30
	PN35	430	381	12	26	M24	44	34	-	38

Drilling for AS 4087 Class PN14 & PN16 is compatible with AS 2129, Table D

Drilling for AS 4087 Class PN21 & PN35 is compatible with AS 2129, Table F & Table H

AS 2129	Table A	405	356	8	22	M20	24	24	19	16
	Table D	405	356	8	22	M20	25	25	19	16
	Table E	405	356	12	22	M20	25	25	22	22
	Table F	430	381	12	26	M24	29	29	25	25
	Table H	430	381	12	26	M24	41	41	35	35

ISO 7005 (DIN)	PN6	375	335	12	18	M16	24	-	20	24
	PN10	395	350	12	22	M20	28	22	22	26
	PN16	405	355	12	26	M24	32	22	24	26
	PN20	405	362	12	26	M24	30	30	25	30.5
	PN25	425	370	12	29.5	M27	36	24.5	30	32
	PN40	450	385	12	32.5	M30	46	34.5	36	38

Drilling Compatible with AS/NZS 4331, BS 4504 & DIN 2533

ANSI B16.5	150	405	362	12	1" - 25.4	7/8" - 22.2	-	-	-	30.2
	300	445	387.4	16	1 1/8" - 28.6	1" - 25.4	-	-	-	47.7
	600	510	431.8	16	1 3/8" - 34.9	1 1/4" - 31.8	-	-	-	63.5

Drilling for ANSI B16.5, Class 150 is compatible with ANSI B16.1, Class 125

Flange dimensions

Nominal size: 300mm

	Class / Table	Outside Diameter	Pitch Circle Diameter	No. Holes	Hole Diameter	Bolt Diameter	Minimum Flange Thickness			
							Cast Iron	Ductile Iron	Copper Alloy	Steel
AS 4087	PN14	455	406	12	22	M20	29	-	-	-
	PN16	455	406	12	22	M20	-	30	-	23
	PN21	490	438	16	26	M24	32	-	-	30
	PN35	490	438	16	26	M24	44	38	-	38

Drilling for AS 4087 Class PN14 & PN16 is compatible with AS 2129, Table D
 Drilling for AS 4087 Class PN21 & PN35 is compatible with AS 2129, Table F & Table H

AS 2129	Table A	455	406	8	22	M20	24	24	22	19
	Table D	455	406	12	22	M20	25	25	22	19
	Table E	455	406	12	26	M24	29	29	25	25
	Table F	490	438	16	26	M24	32	32	29	29
	Table H	490	438	16	26	M24	44	44	38	38

ISO 7005 (DIN)	PN6	440	395	12	22	M20	24	-	22	24
	PN10	445	400	12	22	M20	28	24.5	26	26
	PN16	460	410	12	26	M24	32	24.5	28	28
	PN20	485	432	12	26	M24	32	32	27	32
	PN25	485	430	16	29.5	M27	40	27.5	32	34
	PN40	515	450	16	32.5	M30	50	39.5	40	42

Drilling Compatible with AS/NZS 4331, BS 4504 & DIN 2533

ANSI B16.5	150	485	431.8	12	1" - 25.4	7/8" - 22.2	-	-	-	31.8
	300	520	450.8	16	1 1/4" - 31.8	1 1/8" - 28.6	-	-	-	50.8
	600	560	489	20	1 3/8" - 34.9	1 1/4" - 31.8	-	-	-	66.7

Drilling for ANSI B16.5, Class 150 is compatible with ANSI B16.1, Class 125

Nominal size: 350mm

Class / Table	Outside Diameter	Pitch Circle Diameter	No. Holes	Hole Diameter	Bolt Diameter	Minimum Flange Thickness				
						Cast Iron	Ductile Iron	Copper Alloy	Steel	
AS 4087	DiaPN14	525	470	12	26	M24	32	-	-	-
	PN16	525	470	12	26	M24	-	33	-	30
	PN21	550	495	16	30	M27	35	-	-	30
	PN35	550	495	16	30	M27	48	41	-	48

Drilling for AS 4087 Class PN14 & PN16 is compatible with AS 2129, Table D

Drilling for AS 4087 Class PN21 & PN35 is compatible with AS 2129, Table F & Table H

AS 2129	Table A	525	470	8	26	M24	25	25	25	22
	Table D	525	470	12	26	M24	29	29	25	22
	Table E	525	470	12	26	M24	32	32	25	25
	Table F	550	495	16	30	M27	35	35	32	32
	Table H	550	495	16	30	M27	48	48	41	41

ISO 7005 (DIN)	PN6	490	445	12	22	M20	26	-	22	24
	PN10	505	460	16	22	M20	30	24.5	26	26
	PN16	520	470	16	26	M24	36	26.5	30	30
	PN20	535	476	12	29.5	M27	35	35	35	35
	PN25	555	490	16	32.5	M30	44	30	36	38
	PN40	580	510	16	35.5	M33	54	44	46	46

Drilling Compatible with AS/NZS 4331, BS 4504 & DIN 2533

ANSI B16.5	150	535	476.3	12	1 $\frac{1}{8}$ " - 28.6	1" - 25.4	-	-	-	35
	300	585	514.4	20	1 $\frac{1}{4}$ " - 31.8	1 $\frac{1}{8}$ " - 28.6	-	-	-	54
	600	605	527	20	1 $\frac{1}{2}$ " - 38.1	1 $\frac{3}{8}$ " - 34.9	-	-	-	69.9

Drilling for ANSI B16.5, Class 150 is compatible with ANSI B16.1, Class 125

Flange dimensions

Nominal size: 400mm

	Class / Table	Outside Diameter	Pitch Circle Diameter	No. Holes	Hole Diameter	Bolt Diameter	Minimum Flange Thickness			
							Cast Iron	Ductile Iron	Copper Alloy	Steel
AS 4087	PN14	580	521	12	26	M24	32	-	-	-
	PN16	580	521	12	26	M24	-	33	-	30
	PN21	610	552	20	30	M27	35	-	-	38
	PN35	610	552	20	30	M27	51	44	-	48

Drilling for AS 4087 Class PN14 & PN16 is compatible with AS 2129, Table D
 Drilling for AS 4087 Class PN21 & PN35 is compatible with AS 2129, Table F & Table H

AS 2129	Table A	580	521	12	26	M24	27	27	25	22
	Table D	580	521	12	26	M24	29	29	25	22
	Table E	580	521	12	26	M24	32	32	25	25
	Table F	610	552	20	30	M27	35	35	32	32
	Table H	610	552	20	30	M27	51	51	44	44

ISO 7005 (DIN)	PN6	540	495	16	22	M20	28	-	22	24
	PN10	565	515	16	26	M24	32	24.5	26	26
	PN16	580	525	16	29.5	M27	38	28	32	32
	PN20	600	540	16	29.5	M27	36.5	36.5	37	37
	PN25	620	550	16	35.5	M33	48	32	38	40
	PN40	660	585	16	39	M36	62	48	50	50

Drilling Compatible with AS/NZS 4331, BS 4504 & DIN 2533

ANSI B16.5	150	595	539.8	16	1 1/8" - 28.6	1" - 25.4	-	-	-	36.6
	300	650	571.5	20	1 3/8" - 34.9	1 1/4" - 31.8	-	-	-	57.2
	600	685	603.2	20	1 5/8" - 41.3	1 1/2" - 38.1	-	-	-	76.2

Drilling for ANSI B16.5, Class 150 is compatible with ANSI B16.1, Class 125

