

DK-LOK

Fittings & Valves

Hydraulic Pipe Fittings

Class 2000, 3000, 6000, 9000 Fittings

No. 05-3
June 2015



DK-Lok Hydraulic Pipe Fittings are designed and manufactured to the following standards.

- ASME B 16.11-2005: Forged Fittings, Socket-welding and Threaded
- ASME B 16.14-1991: Ferrous Pipe Plugs, Bushings and Locknuts with Pipe Threads
- JIS B 2316-1991: Steel socket-welding pipe Fittings



VALVE AND FLOW CONTROL SPECIALISTS
SERVICE AND RELIABILITY





VALVE AND FLOW CONTROL SPECIALISTS
SERVICE AND RELIABILITY



The information shown in this catalog are not for design purpose, but for reference only.
The accuracy of information is not the liability of our company.

Safe Component Selection

The Selection of component for any applications or system design must be considered to ensure safe performance. Component function, material compatibility, component ratings, proper installation, operation and maintenance remain the sole responsibility of the system designer and the user. DK-Lok accepts no liability for any improper selection, installation, operation or maintenance.

AUSTRALIAN DISTRIBUTOR: **Brisbane Sydney Melbourne Darwin Perth**
VALVE AND FLOW CONTROL SPECIALISTS PTY LTD
E-mail sales@valveandflowcontrolspecialists.com



Head Quarters and Factory
7, Golden root-ro 129beon-gil, Juchon-myeon, Gimhae-si, Gyeongsangnam-do, South Korea 621-842
Tel. (82) 55-338-0114 Fax. (82) 55-901-0141 www.dklok.com



						Socket Weld Fittings		
Pipe Nipple CN Series		05	Cap CC		11	90° Elbow CL-SW		15
Swaged Nipple CNS Series		06	Hex Nipple CHN		12	45° Elbow CLB-SW		15
Siphon CY Series		07	Male Female Reducer CMFR		12	Tee CT-SW		16
Condensate Pot CP Series		08	Con Reducer CR		13	Cross CX-SW		16
			Eccentric Reducer CER		13	Full Coupling CFC-SW		17
Thread Fittings								
90° Elbow CL		09	Reducing Hex Bushing GHB		13	Half Coupling CHC-SW		17
45° Elbow CLB		09	Hex Head Plug CHP		14	Cap CC-SW		18
Tee CT		10	Square Head Plug CSP		14	Boss CB-SW		18
Cross CX		10	Round Head Plug CRP		14			
Full Coupling CFC		11	Boss CB		14			
Half Coupling CHC		11	Union CU Series		19~20			



Hydraulic Pipe Fittings

Class Ratings

ASME B16.11-2005 specifies the types of Fittings by class designation and DN (NOMINAL DIAMETER) and NPS (NOMINAL PIPE SIZE) range.

Table 1. Fitting Class Rating

DN (NPS)

Description	Socket-Weld Class Designation			Threaded Class Designation		
	3000	6000	9000	2000	3000	6000
	45 DEG., 90 deg. Elbows	DN6-DN100 (1/8-4)	DN6-DN50 (1/8-2)	DN15-DN50 (1/2-2)	DN6-DN100 (1/8-4)	DN6-DN100 (1/8-4)
Tees, Crosses	DN6-DN100 (1/8-4)	DN6-DN50 (1/8-2)	DN15-DN50 (1/2-2)	DN6-DN100 (1/8-4)	DN6-DN100 (1/8-4)	DN6-DN100 (1/8-4)
Coupling, Half-Coupling	DN6-DN100 (1/8-4)	DN6-DN50 (1/8-2)	DN15-DN50 (1/2-2)	...	DN6-DN100 (1/8-4)	DN6-DN100 (1/8-4)
Cap	DN6-DN100 (1/8-4)	DN6-DN100 (1/8-4)	DN15-DN50 (1/2-2)	...	DN6-DN100 (1/8-4)	DN6-DN100 (1/8-4)
Square, Hex, Round Plug	DN6-DN100 (1/8-4) (See Note (1))		
Hex and Flush Bushing	DN6-DN100 (1/8-4) (See Note (1))		

Note: (1) Plugs and bushings are not identified by Class Designation. They may be used for ratings up through Class 6000 designation.

Table 2. NPS vs., DN

NPS	1/8	1/4	3/8	1/2	3/4	1	1-1/4	1-1/2	2	2-1/2	3	4
DN	6	8	10	15	20	25	32	40	50	65	80	100
Pipe OD	Unit: mm											
ANSI	10.29	13.72	17.14	21.34	26.67	33.40	42.16	48.26	60.32	73.02	88.90	114.30
JIS	10.50	13.80	17.30	21.70	27.20	34.00	42.70	48.60	60.50	76.30	89.10	114.30

* NPS: Nominal Pipe size used for inch dimensioned Fittings

* DN: Nominal diameter used for millimeter dimensioned Fittings

Table 3.

Correlation of Fittings class with schedule number or wall designation of pipe for calculation of ratings.

Class Designation of Fitting	Type of Fitting	Pipe Used For Rating Basis (See Note)	
		Schedule No.	Wall Designation
2000	Threaded	80	XS
3000	Threaded	160	...
6000	Threaded	...	XXS
3000	Socket-Welding	80	XS
6000	Socket-Welding	160	...
9000	Socket-Welding	...	XXS

Note :

This table is not intended to restrict the use of pipe of thinner or thicker wall with Fittings. Pipe actually used may be thinner or thicker in nominal wall than that shown in table 3. When thinner pipe is used, its strength may govern the rating. When thicker pipe is used (e.g., for mechanical strength), the strength of the Fittings governs the rating.

Fitting Surface Protection

- Stainless Steel Fittings are cleaned and passivated.
- Carbon Steel Fittings are cleaned and oiled.
- Carbon Steel Fittings with ASTM A123 Hot Dip Galvanized is optional with the ordering designator of "HG".

Marking

Every Fittings is permanently marked complying with the requirements of ASME B16. 11-2005.

Technical Data

Table 4. Pressure - Temperature Ratings

(Unit : psig)

Temperature C (F)	Class 2000 Threaded Fittings			Class 3000 Socket Welding & Threaded Fittings			Class 6000 Socket Welding & Threaded Fittings		
	Carbon Steel	F304	F316	Carbon Steel	F304	F316	Carbon Steel	F304	F316
37 (100)	2000	1715	2000	3000	2570	3000	6000	5145	6000
65 (150)	1970	1615	1970	2950	2425	2950	5915	4855	5915
93 (200)	1940	1520	1940	2915	2280	2915	5830	4565	5830
121 (250)	1915	1445	1915	2875	2170	2875	5750	4340	5750
148 (300)	1895	1370	1896	2845	2055	2845	5690	4115	5690
176 (350)	1875	1310	1875	2810	1965	2810	5625	3930	5625
204 (400)	1850	1245	1850	2775	1870	2775	5550	3745	5550
232 (450)	1810	1195	1810	2715	1790	2715	5430	3585	5430
260 (500)	1735	1140	1735	2605	1715	2605	5210	3430	5210
287 (550)	1640	1100	1640	2460	1650	2460	4925	3305	4925
315 (600)	1540	1060	1540	2310	1590	2310	4620	3180	4620
343 (650)	1430	1020	1430	2150	1535	2150	4300	3070	4300
371 (700)	1305	985	1370	1960	1480	2055	3920	2960	4110
398 (750)	1180	950	1305	1775	1425	1960	3550	2850	3920
426 (800)	1015	915	1240	1525	1370	1865	3050	2745	3730
454 (850)	830	880	1180	1250	1330	1770	2500	2660	3540
482 (900)	615	860	1115	925	1290	1675	1855	2580	3350
510 (950)	425	845	1055	640	1270	1580	1295	2540	3165
537 (1000)	235	830	990	350	1250	1485	715	2500	2975

Table 5. Wall Thickness of Welded and Seamless Pipe

Nominal Pipe Size		Pipe Outside Diameter		Nominal Wall Thickness									
DN	NPS	JIS	ANSI	SPP	SGP	Sch 5s	Sch 10s	Sch 10	Sch 20s	Sch 20	Sch 30	Sch 40s	Sch 40
6	1/8	10.50	10.29	-	-	-	1.24	-	1.5	-	-	1.73	1.73
8	1/4	13.80	13.72	-	-	-	1.65	-	2.0	-	-	2.24	2.24
10	3/8	17.30	17.14	-	-	-	1.65	-	2.0	-	-	2.31	2.31
15	1/2	21.70	21.34	2.8	1.65	2.11	-	-	2.5	-	-	2.77	2.77
20	3/4	27.20	26.67	2.8	1.65	2.11	-	-	2.5	-	-	2.87	2.87
25	1	34.00	33.40	3.2	1.65	2.77	-	-	3.0	-	-	3.38	3.38
32	1 1/4	42.70	42.16	3.5	1.65	2.77	-	-	3.0	-	-	3.56	3.56
40	1 1/2	48.60	48.26	3.5	1.65	2.77	-	-	3.0	-	-	3.68	3.68
50	2	60.50	60.32	3.8	1.65	2.77	-	-	3.5	3.20	-	3.91	3.91
65	2 1/2	76.30	73.02	4.2	2.11	3.05	-	-	3.5	4.50	-	5.16	5.16
80	3	89.10	88.90	4.2	2.11	3.05	-	-	4.0	4.50	-	5.49	5.49

Nominal Pipe Size		Pipe Outside Diameter		Nominal Wall Thickness								
DN	NPS	JIS	ANSI	Sch 60	Sch 80s	X-S	Sch 80	Sch 100	Sch 120	Sch 140	Sch 160	XX-S
6	1/8	10.50	10.29	2.20	2.41	2.41	2.41	-	-	-	3.15	4.83
8	1/4	13.80	13.72	2.40	3.02	3.02	3.02	-	-	-	3.68	6.05
10	3/8	17.30	17.14	2.80	3.20	3.20	3.20	-	-	-	4.01	6.40
15	1/2	21.70	21.34	3.20	3.73	3.73	3.73	-	-	-	4.78	7.47
20	3/4	27.20	26.67	3.40	3.91	3.91	3.91	-	-	-	5.56	7.82
25	1	34.00	33.40	3.90	4.55	4.55	4.55	-	-	-	6.35	9.09
32	1 1/4	42.70	42.16	4.50	4.85	4.85	4.85	-	-	-	6.35	9.70
40	1 1/2	48.60	48.26	4.50	5.08	5.08	5.08	-	-	-	7.14	10.16
50	2	60.50	60.32	4.90	5.54	5.54	5.54	-	-	-	8.74	11.07
65	2 1/2	76.30	73.02	6.00	7.01	7.01	7.01	-	-	-	9.52	14.02
80	3	89.10	88.90	6.60	7.62	7.62	7.62	-	-	-	11.12	15.24

Table 6. Pipe I.D. (Internal Diameter) at Class 3000, 6000, 9000

Pipe Schedule No.		Sch 80	Sch 160	-
Pipe Wall Designation		X-S	-	XX-S
Threaded Pipe Rating		2000	3000	6000
Socket-Welding Pipe Rating		3000	6000	9000
NPS	ANSI PIPE O.D.	ANSI PIPE I.D.		
(Unit : mm)				
1/8	10.29	5.47	3.99	0.63
1/4	13.72	7.68	6.36	1.62
3/8	17.14	10.74	9.12	4.34
1/2	21.34	13.88	11.78	6.40
3/4	26.67	18.85	15.55	11.03
1	33.40	24.30	20.70	15.22
1-1/4	42.16	32.46	29.46	22.76
1-1/2	48.26	38.10	33.98	27.94
2	60.32	49.24	42.84	38.18

Fitting Ordering Information

Select an applicable part number and suffix the Fitting material designator to the part number.

Example : C2L-02R-C

Table 7. Fitting Material Designator

Fitting Materials	Standard	Identifier
Carbon Steel Forgings	ASTM A105	C
	ASTM A105 Normalized	CN
Forged Alloy Steel	ASTM A182 F316	S
	ASTM A182 F316L	L
	ASTM A182 Grade F44 UNS S31254 (6Mo)	M6
	ASTM A182 Grade F11, Class 1, UNS K11597	C1
	ASTM A182 Grade F11, Class 2, UNS K11572	C2
	ASTM A182 Grade F11, Class 3, UNS K11572	C3
Nickel Alloy Forgings	ASTM B564 UNS N04400	M
Forged Alloy	ASTM B462 UNS N08020	L20
	ASTM A276 Type 316 / 316L	S
Cold Drawn Bar Stock	ASTM A276 UNS S31254	M6
	ASTM A164 UNS N04400	M
	ASTM A473 UNS N08020	L20

Fitting with NPT thread

Fitting part number in this catalog is exhibited with ISO 7-1 taper pipe thread of R. To order ASME/ANSI B1.20.1 NPT threaded fitting, replace R with N. Example: C2L-02N-C

Hot Dip Galvanized / NACE MR 0175

Insert "HG" to order hot dip Galvanized Fitting in the part number. To order H₂S Sour Gas service fittings meeting the requirements of NACE MR0175 latest revision, insert "SG" designator in the part number. Example: C2L-02NHGSG-C

Table 8. Pipe Thread Designator

Designator	Standards
R	Taper Pipe Thread, ISO 7-1, BS21 (BSPT), JIS B 0203 (PT), DIN 2999
N	Taper Pipe Thread, ASME / ANSI B1.20.1 (NPT)

Fitting Ordering Information for reducing tees and crosses

Tees are described by first the runs (1), (2) and next the branch (3).

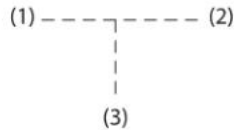

Crosses are described by first the branches (1),(2) and next the runs (3), (4).

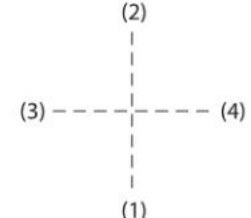

Pipe Nipple

CN Series

Pipe Ordering Information

Example 1: PL 04 8 - 6M - CFA
 Example 2: P 04 8 - 6M - CFA

- PL : Pipe Seamless
- P : Pipe Welded
- 04 : 1/2" Pipe OD. Refer to Table 10.
- 8 : SCH 80, Refer to Table 9.
- 6M : 6 meter length pipe
- CFA : Refer to Table 11.



Table 9. Pipe Schedule Designator

Designator	Pipe SCH
4	SCH 40
8	SCH 80, XS
16	SCH 160
X	XXS

Pipe Nipple Ordering Information

Example: CN 08N 8 - L100 HG SG - CC

- CN : Pipe Nipple
- 08N : 1" NPT Both Ends. Refer to Table 10.
- 8 : SCH 80 Pipe Wall. Refer to Table 9.
- L100 : 100mm Length
- HG : Hot Dip Galvanized
- SG : H₂S Service
- CC : Refer to Table 11.

Full Length Pipe with Both End Threaded

Example: PL 04N 8 - 6M SG - S

- PL : Pipe Seamless
- 04N : 1/2" NPT Both Ends on 1/2" Pipe.
- 8 : SCH 80 Pipe Wall. Refer to Table 9.
- 6M : 6 meter length pipe
- SG : H₂S Service
- S : Refer to Table 11.

Table 10. Pipe Size Designator

Nom.Size	1/8	1/4	3/8	1/2	3/4	1	1-1/4	1-1/2	2
Designator	01	02	03	04	06	08	10	12	16

How to use with the pipe thread's designator.

- 04N : 1/2" NPT pipe thread.
- 08R : 1" ISO 7-1 taper pipe thread.

Table 11. Pipe Material Designator

Pipe	Standard	Identifier
Black & Hot Dipped Galvanized Steel Pipe	ASTM A53 Type F Grade A - Welded	CFA
	ASTM A53 Type E Grade A - Welded	CEA
	ASTM A53 Type E Grade B - Welded	CEB
	ASTM A53 Type S Grade A - Seamless	CSA
	ASTM A53 Type S Grade B - Seamless	CSB
Seamless Carbon Steel Pipe	ASTM A106 Grade A	CA
	ASTM A106 Grade B	CB
	ASTM A106 Grade C	CC
Seamless and Welded Stainless Steel Pipe	ASTM A312 TP316	S
	ASTM A312 TP316L	L
	ASTM A312 TP304	4
	ASTM A312 TP304L	4L
	ASTM A312 UNS 31254	M6
Seamless Ferritic Alloy Steel Pipe	ASTM A335 P11	C11
	ASTM A335 P22	C22
Seamless Nickel-Copper alloy Pipe	ASTM B165 UNS N04400	M
Seamless Nickel Alloy Pipe	ASTM B729 UNS N08020	L20
Seamless Carbon Steel Pipe	API 5L GR. B	A5LB

Swaged Nipple

CNS Series Swaged Nipple

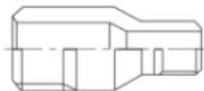

TBE

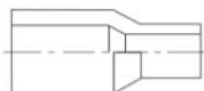

PBE

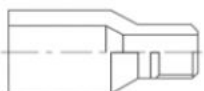

PLE / TSE

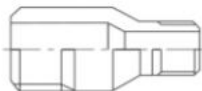

BLE / TSE

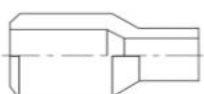

BLE / PSE

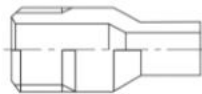

TLE / PSE

Legends

- TBE : Threaded Both End
- PBE : Plain Both End
- PLE / TSE : Plain Large End - Threaded Small End
- BLE / TSE : Beveled Large End - Threaded Small End
- BLE / PSE : Beveled Large End - Plain Small End
- TLE / PSE : Threaded Large End - Plain Small End

Ordering Information

To order CNS Series, prefix "CNS" and build up an ordering number by combining the designator in the sequence below.

Example 1 : CNS 0608N - 8 HG - CA

- **CNS** : Swaged Nipple
- **0608N** : 3/4" and 1" Male NPT Threaded Both End
- **8** : SCH 80 Pipe Wall. Refer to Table 9. Pipe Schedule Designator on page 6.
- **HG** : Hot Dip Galvanized
- **CA** : ASTM A106 Grade A. Refer to Table 11. Pipe Material Designator on page 6.

Example 2 : CNS 04N 08B - 8 - S

- **CNS** : Swaged Nipple
- **04N** : 1/2" NPT Male Threaded End
- **08B** : 1" Beveled End
- **8** : SCH 80 Pipe Wall
- **S** : ASTM A312 TP316.

Example 3 : CNS 04N 08P - 8 - S

- **CNS** : Swaged Nipple
- **04N** : 1/2" NPT Male Threaded End
- **08P** : 1" Plain End
- **8** : SCH 80 Pipe Wall
- **S** : ASTM A312 TP316.

Example 4 : CNS 0408P - 8 - S

- **CNS** : Swaged Nipple
- **0408P** : 1/2" and 1" Plain Both Ends
- **8** : SCH 80 Pipe Wall
- **S** : ASTM A312 TP316.

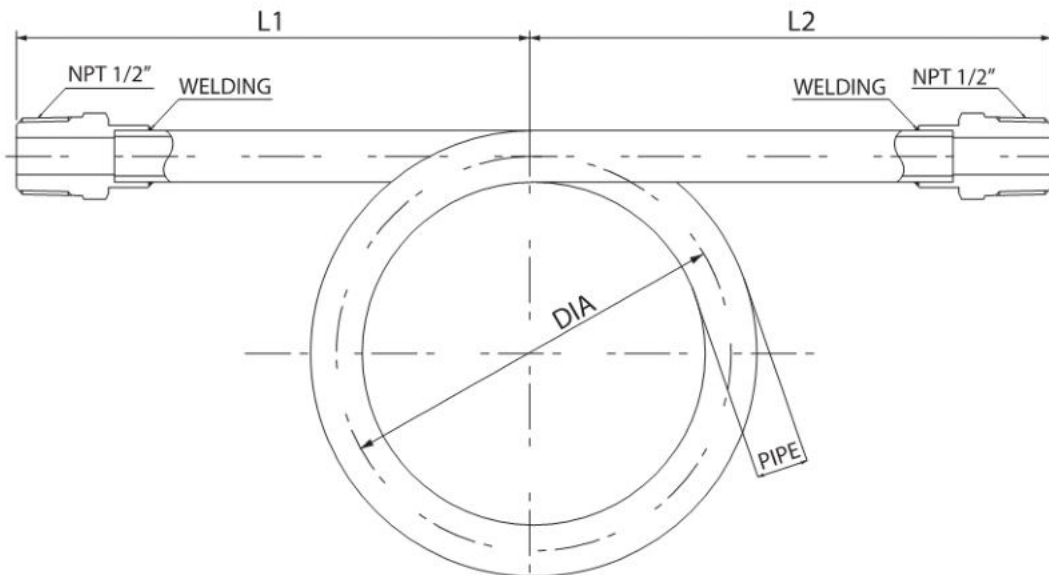
CY Series Siphon**Ordering Information**

Example: CY MF8N - 8T 065 - 700 S

- **CY** : Siphon
- **MF8N** : Male and Female 1/2" NPT Ends.
- **8T** : 1/2" Tube OD
- **065** : 0.065" Wall Thickness Tube
- **700** : 700 mm Length (L1 + L2)
- **S** : Stainless Steel 316

Example: CY M8N - 04 8 - 700 S

- **CY** : Siphon
- **M8N** : Male 1/2" NPT Both Ends.
- **04** : 1/2" Pipe
- **8** : SCH80 Pipe Wall
- **700** : 700 mm Length (L1 + L2)
- **S** : Stainless Steel 316

Condensate Pot CP Series

CP Series Hydraulic Condensate Pots are designed and configured in six layouts. Refer to POT Configuration.

"CP" Series Condensate Pot Part Listing

1	PIPE
2	CAP
3	HALF COUPLING (CHC)
4	VENT PLUG (CVP)
5	HEX HEAD PLUG (CHP)
6	SOCKET WELDING HALF COUPLING (CHCSW)

Table of Dimensions

(Unit : mm)

PIPE	D ANSI Pipe	L	L1*	L2
3"	88.9	214	110	50
4"	114.3	360	229	63.5

* L1 length is adjustable to fit client's requirements.

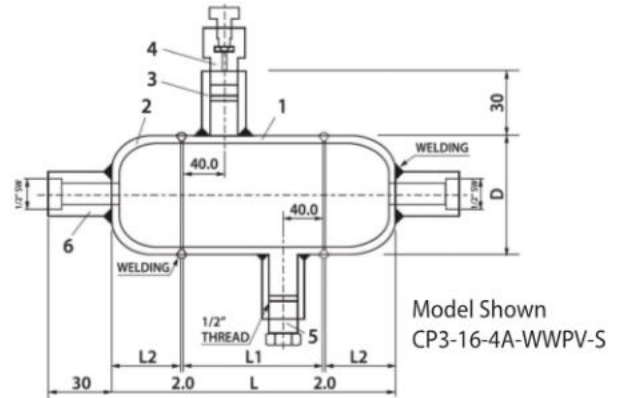

Ordering Information

To order CP Series, prefix "CP" and build up an ordering number by combining the designators in the sequence below.
An example of ordering number: CP3 or CPJ3-16-4A-WWPV-S

CP3 or CPJ3

-16

-4A

-WWPV

-S

ANSI Pipe Designator

Designator	Pipe OD
2	2" ANSI 60.32 mm
3	3" ANSI 88.90 mm
4	4" ANSI 114.30 mm

JIS Pipe Designator

Designator	Pipe OD
J2	2" JIS 60.5 mm
J3	3" JIS 89.1 mm
J4	4" JIS 114.3 mm

Pipe Schedule

Designator	Pipe SCH
4	SCH40
8	SCH 80
16	SCH 160
X	SCH XXS

POT Configuration

Designator	Configuration
2A	
2B	
3A	
3B	
3C	
4A	

POT End Connections

End connectors are described by first the run (1 and 2) and next the branch (3 and 4).

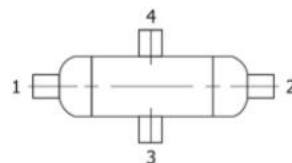

End Connection	Designator	Pipe Material	
		Material	Designator
1/2" NPT Female	N	ASTM A312-TP304	4
1/2" PT Female	R	ASTM A312-TP304L	4L
1/2" SW Socket Weld	W	ASTM A312-TP316	S
1/2" DK-LOK	D	ASTM A312-TP316L	L
Vent Plug (CVP)	V	ASTM A335-P11	C11
Hex head plug (CHP)	P	ASTM A335-P22	C22
		ASTM A106 Grade B	CB

* Fitting Class on end connection is selected as per the Pipe Schedule Rating.

90° Elbow CL

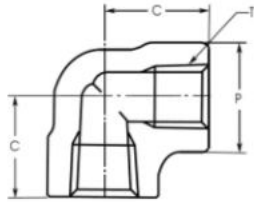

2000 lb

PART No	T(PT)	P	C
C2L-02R	1/4	26.5	25.4
C2L-03R	3/8	26.5	25.4
C2L-04R	1/2	34.0	28.5
C2L-06R	3/4	38.5	33.5
C2L-08R	1	46.5	38.1
C2L-10R	1 1/4	56.5	44.5
C2L-12R	1 1/2	63.5	50.8
C2L-16R	2	76.0	60.5

3000 lb

PART No	T(PT)	P	C
C3L-02R	1/4	26.5	25.4
C3L-03R	3/8	34.0	28.5
C3L-04R	1/2	38.5	33.5
C3L-06R	3/4	46.5	38.1
C3L-08R	1	56.5	44.5
C3L-10R	1 1/4	63.5	50.8
C3L-12R	1 1/2	76.0	60.5
C3L-16R	2	84.0	64.0

6000 lb

PART No	T(PT)	P	C
C6L-03R	3/8	38.5	33.5
C6L-04R	1/2	46.5	38.5
C6L-06R	3/4	56.5	44.5
C6L-08R	1	63.5	50.8
C6L-10R	1 1/4	76.0	60.5
C6L-12R	1 1/2	84.0	64.0
C6L-16R	2	110.0	85.0

45° Elbow CLB

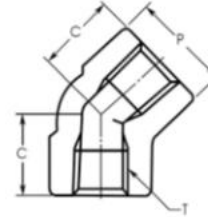

2000 lb

PART No	T(PT)	P	C
C2LB-02R	1/4	26.5	19.1
C2LB-03R	3/8	26.5	19.1
C2LB-04R	1/2	34.0	26.0
C2LB-06R	3/4	38.5	28.6
C2LB-08R	1	46.5	30.0
C2LB-10R	1 1/4	56.5	33.3
C2LB-12R	1 1/2	63.5	42.0
C2LB-16R	2	76.0	46.0

3000 lb

PART No	T(PT)	P	C
C3LB-02R	1/4	26.5	19.1
C3LB-03R	3/8	34.0	26.0
C3LB-04R	1/2	38.5	28.6
C3LB-06R	3/4	46.5	30.0
C3LB-08R	1	56.5	33.3
C3LB-10R	1 1/4	63.5	42.0
C3LB-12R	1 1/2	76.0	46.0
C3LB-16R	2	84.0	53.0

6000 lb

PART No	T(PT)	P	C
C6LB-03R	3/8	38.5	28.6
C6LB-04R	1/2	46.5	30.0
C6LB-06R	3/4	56.5	33.3
C6LB-08R	1	63.5	42.0
C6LB-10R	1 1/4	76.0	46.0
C6LB-12R	1 1/2	84.0	53.0
C6LB-16R	2	110.0	64.0

Tee
|CT

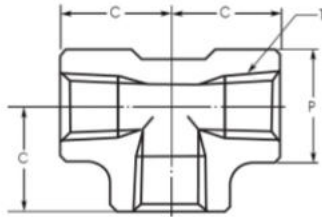

2000 lb

PART No	T(PT)	P	C
C2T-02R	1/4	26.5	25.4
C2T-03R	3/8	26.5	25.4
C2T-04R	1/2	34.0	28.5
C2T-06R	3/4	38.5	33.5
C2T-08R	1	46.5	38.1
C2T-10R	1 1/4	56.5	44.5
C2T-12R	1 1/2	63.5	50.8
C2T-16R	2	76.0	60.5

Cross
|CX

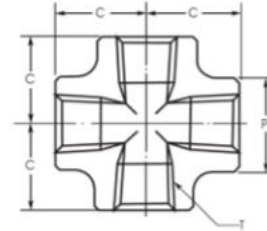

2000 lb

PART No	T(PT)	P	C
C2X-02R	1/4	26.5	25.4
C2X-03R	3/8	26.5	25.4
C2X-04R	1/2	34.0	28.5
C2X-06R	3/4	38.5	33.5
C2X-08R	1	46.5	38.1
C2X-10R	1 1/4	56.5	44.5
C2X-12R	1 1/2	63.5	50.8
C2X-16R	2	76.0	60.5

3000 lb

PART No	T(PT)	P	C
C3T-02R	1/4	26.5	25.4
C3T-03R	3/8	34.0	28.5
C3T-04R	1/2	38.5	33.5
C3T-06R	3/4	46.5	38.1
C3T-08R	1	56.5	44.5
C3T-10R	1 1/4	63.5	50.8
C3T-12R	1 1/2	76.0	60.5
C3T-16R	2	92.0	67.0

3000 lb

PART No	T(PT)	P	C
C3X-02R	1/4	26.5	25.4
C3X-03R	3/8	34.0	28.5
C3X-04R	1/2	38.5	33.5
C3X-06R	3/4	46.5	38.1
C3X-08R	1	56.5	44.5
C3X-10R	1 1/4	63.5	50.8
C3X-12R	1 1/2	76.0	60.5
C3X-16R	2	84.0	64.0

6000 lb

PART No	T(PT)	P	C
C6T-03R	3/8	38.5	33.5
C6T-04R	1/2	46.5	38.5
C6T-06R	3/4	56.5	44.5
C6T-08R	1	63.5	50.8
C6T-10R	1 1/4	76.0	60.5
C6T-12R	1 1/2	84.0	64.0
C6T-16R	2	110.0	85.0

6000 lb

PART No	T(PT)	P	C
C6X-03R	3/8	38.5	33.5
C6X-04R	1/2	46.5	38.1
C6X-06R	3/4	56.5	44.5
C6X-08R	1	63.5	50.8
C6X-10R	1 1/4	76.0	60.5
C6X-12R	1 1/2	84.0	64.0
C6X-16R	2	110.0	83.0

Full Coupling CFC

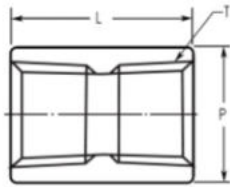

Half Coupling CHC

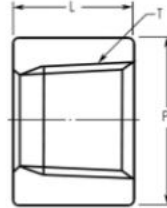

Cap CC

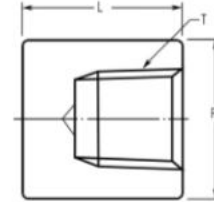

2000 lb

PART No	T(PT)	P	L
C2FC-02R	1/4	19.0	35.0
C2FC-03R	3/8	22.0	38.0
C2FC-04R	1/2	28.5	48.0
C2FC-06R	3/4	35.0	51.0
C2FC-08R	1	44.5	61.0
C2FC-10R	1 1/4	57.0	67.0
C2FC-12R	1 1/2	63.5	80.0
C2FC-16R	2	76.0	86.0

2000 lb

PART No	T(PT)	P	L
C2HC-02R	1/4	19.0	17.5
C2HC-03R	3/8	22.0	19.0
C2HC-04R	1/2	28.5	24.0
C2HC-06R	3/4	35.0	25.5
C2HC-08R	1	44.5	30.5
C2HC-10R	1 1/4	57.0	33.5
C2HC-12R	1 1/2	63.5	40.0
C2HC-16R	2	76.0	43.0

2000 lb

PART No	T(PT)	P	L
C2C-02R	1/4	19.0	25.5
C2C-03R	3/8	22.0	25.0
C2C-04R	1/2	28.5	32.0
C2C-06R	3/4	35.0	37.0
C2C-08R	1	44.5	41.0
C2C-10R	1 1/4	57.0	44.0
C2C-12R	1 1/2	63.5	44.0
C2C-16R	2	76.0	48.0

3000 lb

PART No	T(PT)	P	L
C3FC-02R	1/4	19.0	35.0
C3FC-03R	3/8	22.0	38.0
C3FC-04R	1/2	28.5	48.0
C3FC-06R	3/4	35.0	51.0
C3FC-08R	1	44.5	61.0
C3FC-10R	1 1/4	57.0	67.0
C3FC-12R	1 1/2	63.5	80.0
C3FC-16R	2	76.0	86.0

3000 lb

PART No	T(PT)	P	L
C3HC-02R	1/4	19.0	17.5
C3HC-03R	3/8	22.0	19.0
C3HC-04R	1/2	28.5	24.0
C3HC-06R	3/4	35.0	25.5
C3HC-08R	1	44.5	30.5
C3HC-10R	1 1/4	57.0	33.5
C3HC-12R	1 1/2	63.5	40.0
C3HC-16R	2	76.0	43.0

3000 lb

PART No	T(PT)	P	L
C3C-02R	1/4	19.0	25.5
C3C-03R	3/8	22.0	25.0
C3C-04R	1/2	28.5	32.0
C3C-06R	3/4	35.0	37.0
C3C-08R	1	44.5	41.0
C3C-10R	1 1/4	57.0	44.0
C3C-12R	1 1/2	63.5	44.0
C3C-16R	2	76.0	48.0

6000 lb

PART No	T(PT)	P	L
C6FC-02R	1/4	25.4	35.0
C6FC-03R	3/8	31.8	38.0
C6FC-04R	1/2	38.1	48.0
C6FC-06R	3/4	44.5	51.0
C6FC-08R	1	57.0	61.0
C6FC-10R	1 1/4	63.5	67.0
C6FC-12R	1 1/2	76.0	80.0
C6FC-16R	2	92.0	86.0

6000 lb

PART No	T(PT)	P	L
C6HC-02R	1/4	25.4	17.5
C6HC-03R	3/8	31.8	19.0
C6HC 04R	1/2	38.1	24.0
C6HC 06R	3/4	44.5	25.5
C6HC 08R	1	57.0	30.5
C6HC 10R	1 1/4	63.5	33.5
C6HC 12R	1 1/2	76.0	40.0
C6HC 16R	2	92.0	43.0

6000 lb

PART No	T(PT)	P	L
C6C-02R	1/4	25.4	27.0
C6C-03R	3/8	31.8	27.0
C6C-04R	1/2	38.1	33.0
C6C-06R	3/4	44.5	38.0
C6C-08R	1	57.0	43.0
C6C-10R	1 1/4	63.5	46.0
C6C-12R	1 1/2	76.0	48.0
C6C-16R	2	92.0	51.0

Hex Nipple
CHN

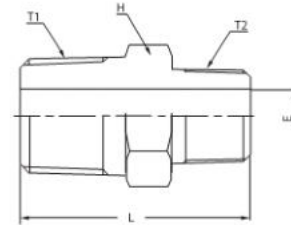
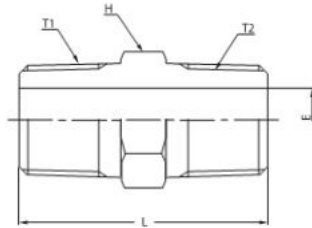

3000 lb/6000 lb

PART No	T1 - T2	E	H	L
C6HN-01R	1/8	4.1	12	26
C6HN-02R	1/4	7.1	17	36
C6HN-03R	3/8	8.9	19	36
C6HN-04R	1/2	11.9	24	47
C6HN-06R	3/4	16.0	30	48
C6HN-08R	1	20.1	36	59
C6HN-10R	1 1/4	27.9	46	60
C6HN-12R	1 1/2	32.0	50	64
C6HN-16R	2	39.9	65	68

3000 lb/6000 lb

PART No	T1 - T2	E	H	L
C6HN-0302R	3/8-1/4	7.1	19	36
C6HN-0402R	1/2-1/4	7.1	24	42
C6HN-0403R	1/2-3/8	8.9	24	42
C6HN-0602R	3/4-1/4	7.1	30	43
C6HN-0603R	3/4-3/8	8.9	30	43
C6HN-0604R	3/4-1/2	11.9	30	48
C6HN-0803R	1-3/8	8.9	36	49
C6HN-0804R	1-1/2	11.9	36	54
C6HN-0806R	1-3/4	16.0	36	54
C6HN-1004R	1 1/4-1/2	11.9	46	55
C6HN-1006R	1 1/4-3/4	16.0	46	55
C6HN-1008R	1 1/4-1	20.1	46	60
C6HN-1206R	1 1/2-3/4	16.0	50	58
C6HN-1208R	1 1/2-1	20.1	50	63
C6HN-1210R	1 1/2-1 1/4	27.9	50	63
C6HN-1608R	2 - 1	20.1	65	66
C6HN-1610R	2-1 1/4	27.9	65	66
C6HN-1612R	2-1 1/2	32.0	65	67
C6HN-2010R	2 1/2-1 1/4	27.9	80	80
C6HN-2012R	2 1/2-1 1/2	32.0	80	81
C6HN-2016R	2 1/2-2	39.9	80	82

Male Female Reducer
CMFR

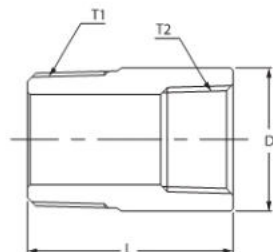

3000 lb

PART No	T1 - T2	L	D
C3MFR-0604R	3/4 - 1/2	44	29.0
C3MFR-0804R	1 - 1/2	51	33.4
C3MFR-0806R	1 - 3/4	51	35.0
C3MFR-1604R	2 - 1/2	70	60.3
C3MFR-1608R	2 - 1	70	60.3

Con Reducer

CR

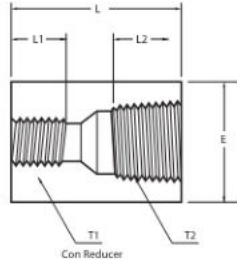

Eccentric Reducer

CER

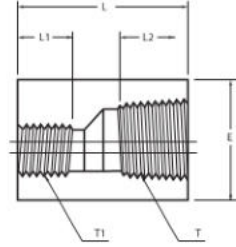

3000 lb

PART No	T1 - T2	E	L
C3R-0201R	1/4-1/8	19	35
C3R-0302R	3/8-1/4	22	38
C3R-0402R	1/2-1/4	29	48
C3R-0403R	1/2-3/8	29	48
C3R-0602R	3/4-1/4	35	51
C3R-0603R	3/4-3/8	35	51
C3R-0604R	3/4-1/2	35	51
C3R-0803R	1-3/8	44	60
C3R-0804R	1-1/2	44	60
C3R-0806R	1-3/4	44	60
C3R-1004R	1 1/4-1/2	57	67
C3R-1006R	1 1/4-3/4	57	67
C3R-1008R	1 1/4-1	57	67
C3R-1206R	1 1/2-3/4	64	79

Dimensions of Concentric Reducer (CR) and Eccentric Reducer (CER) are identical. To order CER, replace CR with CER.

Example:

Con Reducer's Part No.: C3R-0201R

Eccentric Reducer's Part No.: C3ER-0201R

6000 lb

PART No	T1 - T2	E	L
C6R-0201R	1/4-1/8	25	6.5
C6R-0302R	3/8-1/4	32	8.0
C6R-0402R	1/2-1/4	38	8.0
C6R-0403R	1/2-3/8	38	9.0
C6R-0602R	3/4-1/4	44	8.0
C6R-0603R	3/4-3/8	44	9.0
C6R-0604R	3/4-1/2	44	11.0
C6R-0803R	1-3/8	57	9.0
C6R-0804R	1-1/2	57	11.0
C6R-0806R	1-3/4	57	12.5
C6R-1004R	1 1/4-1/2	64	11.0
C6R-1006R	1 1/4-3/4	64	12.5
C6R-1008R	1 1/4-1	64	14.5
C6R-1206R	1 1/2-3/4	76	12.5

Reducing Hex Bushing

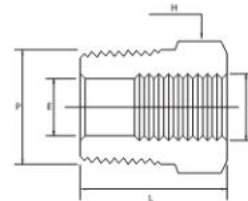

Refer GHB (Reducing Hex Bushing) to DK-LOK Instrumentation Pipe & Weld catalog # 03- latest revision.

Hex Head Plug

CHP

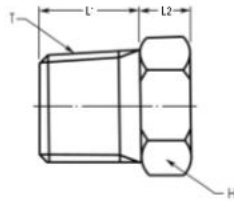

3000 lb / 6000 lb

PART No	T(PT)	L1	L2	H
C6HP-01R	1/8	11.0	6.3	11.0
C6HP-02R	1/4	13.0	6.3	16.0
C6HP-03R	3/8	14.0	8.0	18.0
C6HP-04R	1/2	18.0	8.0	22.0
C6HP-06R	3/4	19.0	10.0	27.0
C6HP-08R	1	21.0	10.0	35.0
C6HP-10R	1 1/4	22.0	14.0	44.0
C6HP-12R	1 1/2	24.0	16.0	51.0
C6HP-16R	2	25.0	18.0	63.5

Square Head Plug

CSP

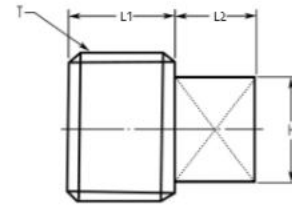

3000 lb / 6000 lb

PART No	T(PT)	L1	L2	H
C6SP-01R	1/8	9.9	6.6	7.0
C6SP-02R	1/4	13.0	6.6	9.5
C6SP-03R	3/8	13.0	7.9	11.0
C6SP-04R	1/2	15.0	9.9	14.5
C6SP-06R	3/4	16.0	11.0	16.0
C6SP-08R	1	20.1	13.0	21.0
C6SP-10R	1 1/4	21.1	15.0	24.0
C6SP-12R	1 1/2	21.1	16.0	28.5
C6SP-16R	2	23.1	18.0	33.5

Round Head Plug(Cylindrical Head Plug)

CRP



3000 lb / 6000 lb

PART No	T(PT)	P	L
C6RP-01R	1/8	10.3	35.0
C6RP-02R	1/4	13.5	41.3
C6RP-03R	3/8	17.5	41.3
C6RP-04R	1/2	21.4	44.5
C6RP-06R	3/4	27.0	44.5
C6RP-08R	1	33.4	50.8
C6RP-10R	1 1/4	42.9	50.8
C6RP-12R	1 1/2	48.4	50.8
C6RP-16R	2	60.3	63.5

Boss

CB

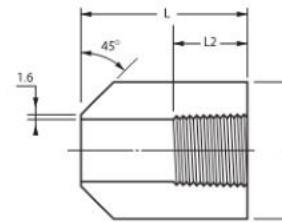

3000 lb

PART No	T(PT)		M	L	L2
	B	A			
C3B-02R	1/4	8	19	40	8.0
C3B-03R	3/8	10	22	45	9.0
C3B-04R	1/2	15	29	50	11.0
C3B-06R	3/4	20	35	50	12.5
C3B-08R	1	25	44	50	14.5
C3B-10R	1 1/4	32	57	50	17.0
C3B-12R	1 1/2	40	64	50	18.0
C3B-16R	2	50	76	50	19.0

6000 lb

PART No	T(PT)		M	L	L2
	B	A			
C6B-02R	1/4	8	25	40	8.0
C6B-03R	3/8	10	32	45	9.0
C6B-04R	1/2	15	38	50	11.0
C6B-06R	3/4	20	44	50	12.5
C6B-08R	1	25	57	50	14.5
C6B-10R	1 1/4	32	64	50	17.0
C6B-12R	1 1/2	40	76	50	18.0
C6B-16R	2	50	92	50	19.0

90° Elbow CL-SW

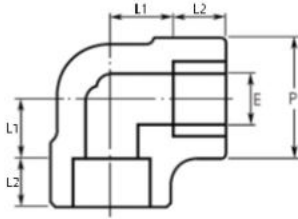

3000 lb

PART No	SW	P	E	L1	L2
C3L-02SW	1/4	26.5	9.4	11.1	10.0
C3L-03SW	3/8	26.5	12.7	13.4	10.0
C3L-04SW	1/2	34.0	16.1	16.0	13.0
C3L-06SW	3/4	38.5	21.2	20.0	14.0
C3L-08SW	1	46.5	27.0	23.0	15.0
C3L-10SW	1 1/4	56.5	35.4	28.0	17.0
C3L-12SW	1 1/2	63.5	41.2	33.0	18.0
C3L-16SW	2	76.0	52.7	39.0	22.0

6000 lb

PART No	SW	P	E	L1	L2
C6L-04SW	1/2	38.5	12.0	20.0	16.0
C6L-06SW	3/4	46.5	15.8	23.0	16.0
C6L-08SW	1	56.5	21.0	28.0	18.0
C6L-10SW	1 1/4	63.5	29.7	33.0	20.0
C6L-12SW	1 1/2	76.0	34.2	40.0	22.0
C6L-16SW	2	84.0	43.1	42.0	24.0

9000 lb

PART No	SW	P	E	L1	L2
C9L-04SW	1/2	46.5	6.4	23.0	16.0
C9L-06SW	3/4	56.5	11.0	28.0	16.0
C9L-08SW	1	63.5	15.2	33.0	18.0
C9L-10SW	1 1/4	76.0	22.7	40.0	20.0
C9L-12SW	1 1/2	84.0	27.9	42.0	22.0
C9L-16SW	2	110.0	38.1	54.0	24.0

45° Elbow CLB-SW

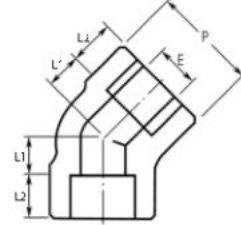

3000 lb

PART No	SW	P	E	L1	L2
C3LB-02SW	1/4	26.5	9.4	7.9	10.0
C3LB-03SW	3/8	26.5	12.7	7.9	10.0
C3LB-04SW	1/2	34.0	16.1	13.0	13.0
C3LB-06SW	3/4	38.5	21.2	13.0	14.0
C3LB-08SW	1	46.5	27.0	14.0	15.0
C3LB-10SW	1 1/4	56.5	35.4	18.0	17.0
C3LB-12SW	1 1/2	63.5	41.2	22.0	18.0
C3LB-16SW	2	76.0	52.7	24.0	22.0

6000 lb

PART No	SW	P	E	L1	L2
C6LB-04SW	1/2	38.5	12.0	13.0	16.0
C6LB-06SW	3/4	46.5	15.8	14.0	16.0
C6LB-08SW	1	56.5	21.0	22.0	18.0
C6LB-10SW	1 1/4	63.5	29.7	22.0	20.0
C6LB-12SW	1 1/2	76.0	34.2	24.0	22.0
C6LB-16SW	2	84.0	43.1	29.0	24.0

9000 lb

PART No	SW	P	E	L1	L2
C9LB-04SW	1/2	46.5	6.4	14.0	16.0
C9LB-06SW	3/4	56.5	11.0	22.0	16.0
C9LB-08SW	1	63.5	15.2	22.0	18.0
C9LB-10SW	1 1/4	76.0	22.7	24.0	20.0
C9LB-12SW	1 1/2	84.0	27.9	29.0	22.0
C9LB-16SW	2	110.0	38.1	34.0	24.0

Tee
CT-SW

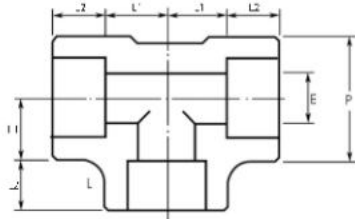

3000 lb

PART No	SW	P	E	L1	L2
C3T-02SW	1/4	26.5	9.4	11.1	10.0
C3T-03SW	3/8	26.5	12.7	13.4	10.0
C3T-04SW	1/2	34.0	16.1	16.0	13.0
C3T-06SW	3/4	38.5	21.2	20.0	14.0
C3T-08SW	1	46.5	27.0	23.0	15.0
C3T-10SW	1 1/4	56.5	35.4	28.0	17.0
C3T-12SW	1 1/2	63.5	41.2	33.0	18.0
C3T-16SW	2	76.0	52.7	39.0	22.0

6000 lb

PART No	SW	P	E	L1	L2
C6T-04SW	1/2	38.5	12.0	20.0	16.0
C6T-06SW	3/4	46.5	15.8	23.0	16.0
C6T-08SW	1	56.5	21.0	28.0	18.0
C6T-10SW	1 1/4	63.5	29.7	33.0	20.0
C6T-12SW	1 1/2	76.0	34.2	40.0	22.0
C6T-16SW	2	84.0	43.1	42.0	24.0

9000 lb

PART No	SW	P	E	L1	L2
C9T-04SW	1/2	46.5	6.4	23.0	16.0
C9T-06SW	3/4	56.5	11.0	28.0	16.0
C9T-08SW	1	63.5	15.2	33.0	18.0
C9T-10SW	1 1/4	76.0	22.7	40.0	20.0
C9T-12SW	1 1/2	84.0	27.9	42.0	22.0
C9T-16SW	2	110.0	38.1	54.0	24.0

Cross
CX-SW

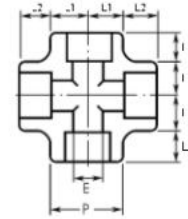

3000 lb

PART No	SW	P	E	L1	L2
C3X-02SW	1/4	26.5	9.4	7.9	10.0
C3X-03SW	3/8	26.5	12.7	7.9	10.0
C3X-04SW	1/2	34.0	16.1	13.0	13.0
C3X-06SW	3/4	38.5	21.2	13.0	14.0
C3X-08SW	1	46.5	27.0	14.0	15.0
C3X-10SW	1 1/4	56.5	35.4	18.0	17.0
C3X-12SW	1 1/2	63.5	41.2	22.0	18.0
C3X-16SW	2	76.0	52.7	24.0	22.0

6000 lb

PART No	SW	P	E	L1	L2
C6X-04SW	1/2	38.5	12.0	13.0	16.0
C6X-06SW	3/4	46.5	15.8	14.0	16.0
C6X-08SW	1	56.5	21.0	22.0	18.0
C6X-10SW	1 1/4	63.5	29.7	22.0	20.0
C6X-12SW	1 1/2	76.0	34.2	24.0	22.0
C6X-16SW	2	84.0	43.1	29.0	24.0

9000 lb

PART No	SW	P	E	L1	L2
C9X-04SW	1/2	46.5	6.4	14.0	16.0
C9X-06SW	3/4	56.5	11.0	22.0	16.0
C9X-08SW	1	63.5	15.2	22.0	18.0
C9X-10SW	1 1/4	76.0	22.7	24.0	20.0
C9X-12SW	1 1/2	84.0	27.9	29.0	22.0
C9X-16SW	2	110.0	38.1	34.0	24.0

Full Coupling CFC-SW

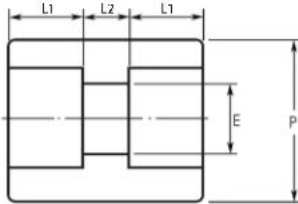

3000 lb

PART No	SW	P	E	L1	L2
C3FC-02SW	1/4	26.5	9.4	11.1	10.0
C3FC-03SW	3/8	26.5	12.7	13.4	10.0
C3FC-04SW	1/2	34.0	16.1	16.0	13.0
C3FC-06SW	3/4	38.5	21.2	20.0	14.0
C3FC-08SW	1	46.5	27.0	23.0	15.0
C3FC-10SW	1 1/4	56.5	35.4	28.0	17.0
C3FC-12SW	1 1/2	63.5	41.2	33.0	18.0
C3FC-16SW	2	76.0	52.7	39.0	22.0

6000 lb

PART No	SW	P	E	L1	L2
C6FC-04SW	1/2	38.5	12.0	10.0	9.6
C6FC-06SW	3/4	46.5	15.8	13.0	9.6
C6FC-08SW	1	56.5	21.0	13.0	12.7
C6FC-10SW	1 1/4	63.5	29.7	13.0	12.7
C6FC-12SW	1 1/2	76.0	34.2	13.0	12.7
C6FC-16SW	2	84.0	43.1	16.0	19.1

9000 lb

PART No	SW	P	E	L1	L2
C9FC-04SW	1/2	46.5	6.4	10.0	9.6
C9FC-06SW	3/4	56.5	11.0	13.0	9.6
C9FC-08SW	1	63.5	15.2	13.0	12.7
C9FC-10SW	1 1/4	76.0	22.7	13.0	12.7
C9FC-12SW	1 1/2	84.0	27.9	13.0	12.7
C9FC-16SW	2	110.0	38.1	16.0	19.1

Half Coupling CHC-SW

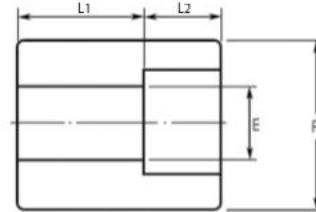

3000 lb

PART No	SW	P	E	L1	L2
C3HC-02SW	1/4	26.5	9.4	11.1	10.0
C3HC-03SW	3/8	26.5	12.7	13.4	10.0
C3HC-04SW	1/2	34.0	16.1	16.0	13.0
C3HC-06SW	3/4	38.5	21.2	20.0	14.0
C3HC-08SW	1	46.5	27.0	23.0	15.0
C3HC-10SW	1 1/4	56.5	35.4	28.0	17.0
C3HC-12SW	1 1/2	63.5	41.2	33.0	18.0
C3HC-16SW	2	76.0	52.7	39.0	22.0

6000 lb

PART No	SW	P	E	L1	L2
C6HC-04SW	1/2	32.6	12.0	10.0	22.4
C6HC-06SW	3/4	40.0	15.8	13.0	23.9
C6HC-08SW	1	48.5	21.0	13.0	28.4
C6HC-10SW	1 1/4	57.2	29.7	13.0	30.2
C6HC-12SW	1 1/2	64.7	34.2	13.0	31.8
C6HC-16SW	2	80.3	43.1	16.0	41.1

9000 lb

PART No	SW	P	E	L1	L2
C9HC-04SW	1/2	40.4	6.4	10.0	22.4
C9HC-06SW	3/4	45.5	11.0	13.0	23.9
C9HC-08SW	1	55.0	15.2	13.0	28.4
C9HC-10SW	1 1/4	66.5	22.7	13.0	30.2
C9HC-12SW	1 1/2	73.0	27.9	13.0	31.8
C9HC-16SW	2	88.0	38.1	16.0	41.1

Cap
CC-SW

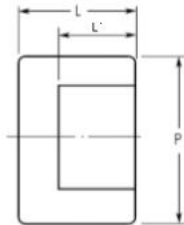

3000 lb

PART No	SW	P	E	L	L1
C3C-02SW	1/4	21.0	10.0	20.0	10.0
C3C-03SW	3/8	25.0	10.0	20.0	10.0
C3C-04SW	1/2	31.0	10.0	20.0	13.0
C3C-06SW	3/4	36.3	13.0	25.0	14.0
C3C-08SW	1	44.5	13.0	27.0	15.0
C3C-10SW	1 1/4	54.0	13.0	30.0	17.0
C3C-12SW	1 1/2	60.3	13.0	30.0	18.0
C3C-16SW	2	73.5	16.0	36.0	22.0

6000 lb

PART No	SW	P	E	L	L1
C6C-02SW	1/2	32.6	10.0	26.0	16.0
C6C-03SW	3/4	40.0	13.0	27.0	16.0
C6C-04SW	1	48.5	13.0	30.0	18.0
C6C-06SW	1 1/4	57.2	13.0	35.0	20.0
C6C-08SW	1 1/2	64.7	13.0	36.0	22.0
C6C-10SW	2	80.3	16.0	39.0	24.0

9000 lb

0.5	SW	P	E	L	L1
C9C-02SW	1/2	40.4	10.0	30.0	16.0
C9C-03SW	3/4	45.5	13.0	30.0	16.0
C9C-04SW	1	55.0	13.0	33.0	18.0
C9C-06SW	1 1/4	66.5	13.0	40.0	20.0
C9C-08SW	1 1/2	73.0	13.0	40.0	22.0
C9C-10SW	2	88.0	16.0	43.0	24.0

Boss
CB-SW

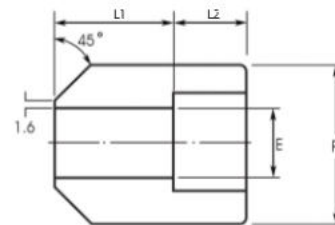

3000 lb

PART No	SW	P	E	L1	L2
C3B-02SW	1/4	21.0	9.4	10.0	20.0
C3B-03SW	3/8	25.0	12.7	10.0	20.0
C3B-04SW	1/2	31.0	16.1	10.0	23.0
C3B-06SW	3/4	36.3	21.2	13.0	22.0
C3B-08SW	1	44.5	27.0	13.0	30.0
C3B-10SW	1 1/4	54.0	35.4	13.0	33.0
C3B-12SW	1 1/2	60.3	41.2	13.0	37.0
C3B-16SW	2	73.5	52.7	16.0	41.0

6000 lb

PART No	SW	P	E	L1	L2
C6B-04SW	1/2	32.6	12.0	10.0	23.0
C6B-06SW	3/4	40.0	15.8	13.0	22.0
C6B-08SW	1	48.5	21.0	13.0	30.0
C6B-10SW	1 1/4	57.2	29.7	13.0	33.0
C6B-12SW	1 1/2	64.7	34.2	13.0	37.0
C6B-16SW	2	80.3	43.1	16.0	41.0

9000 lb

PART No	SW	P	E	L1	L2
C9B-04SW	1/2	38.1	6.4	10	23.0
C9B-06SW	3/4	44.3	11.0	13	22.0
C9B-08SW	1	64.2	15.2	13	30.0
C9B-10SW	1 1/4	63.8	22.7	13	33.0
C9B-12SW	1 1/2	71.1	27.9	13	37.0
C9B-16SW	2	85.5	38.1	16	41.0

Tread Union CU

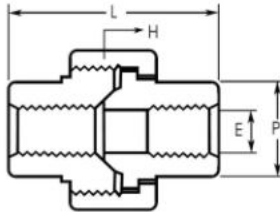

3000 lb

PART No	T(PT)	P	E	L	H
C3U-01R	1/8	14.7	6.43	41.4	16.0
C3U-02R	1/4	19.0	9.45	41.4	16.0
C3U-03R	3/8	22.9	13.51	46.0	14.0
C3U-04R	1/2	27.7	17.07	49.0	14.0
C3U-06R	3/4	33.5	21.39	56.9	11.0
C3U-08R	1	41.4	27.74	62.0	11.0
C3U-10R	1 1/4	50.5	35.36	71.1	11.0
C3U-12R	1 1/2	57.2	41.20	76.4	10.0
C3U-16R	2	70.1	52.12	86.1	10.0

Socket Weld Union CU-SW

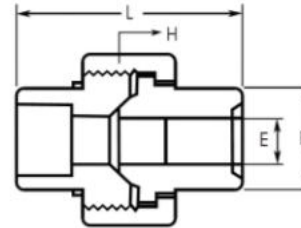

3000 lb

PART No	SW	P	E	L	H
C3U-01SW	1/8	21.8	6.43	41.4	16.0
C3U-02SW	1/4	21.8	9.45	41.4	16.0
C3U-03SW	3/8	25.9	13.51	46.0	14.0
C3U-04SW	1/2	31.2	17.07	49.0	14.0
C3U-06SW	3/4	37.1	21.39	56.9	11.0
C3U-08SW	1	45.5	27.74	62.0	11.0
C3U-10SW	1 1/4	54.9	35.36	71.1	11.0
C3U-12SW	1 1/2	61.5	41.20	76.4	10.0
C3U-16SW	2	75.2	52.12	86.1	10.0

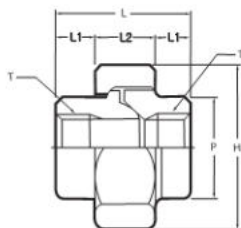

6000 lb

PART No	T(PT)	P	L1	L2	L	H
C6U-02R	1/4	25.4	13.5	19.0	46.0	40 HEX
C6U-03R	3/8	32.0	15.0	21.0	51.0	46 HEX
C6U-04R	1/2	40.0	17.0	23.0	57.0	56 HEX
C6U-06R	3/4	44.5	19.5	25.0	64.0	65 HEX
C6U-08R	1	51.0	22.5	27.0	72.0	74 OCT
C6U-10R	1 1/4	57.2	24.0	30.0	78.0	83 OCT
C6U-12R	1 1/2	71.5	26.0	36.0	88.0	103 OCT
C6U-16R	2	90.0	34.0	42.0	110.0	124 OCT

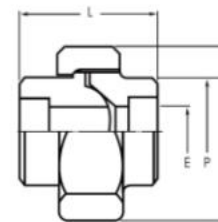

6000 lb

PART No	SW	P	E	L	H
C6U-04SW	1/2	40.0	12.0	57.0	56 HEX
C6U-06SW	3/4	44.5	15.8	64.0	65 HEX
C6U-08SW	1	51.0	21.0	72.0	74 OCT
C6U-10SW	1 1/4	57.2	29.7	78.0	83 OCT
C6U-12SW	1 1/2	71.5	34.2	88.0	103 OCT
C6U-16SW	2	90.0	43.1	110.0	124 OCT

Thread Union O-ring Type

CUO

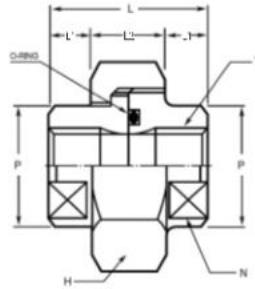

3000 lb

PART No	T(PT)	P	L1	L2	L	H	N	O-ring
C3UO-02R	1/4	22.0	10.0	18.0	38.0	35 HEX	21.0	P18
C3UO-03R	3/8	27.0	10.0	18.0	38.0	41 HEX	26.0	P20
C3UO-04R	1/2	32.0	12.0	20.0	44.0	46 HEX	32.0	G25
C3UO-06R	3/4	38.0	12.0	26.0	50.0	54 HEX	38.0	G30
C3UO-08R	1	47.0	15.0	26.0	56.0	63 OCT	46.0	G35
C3UO-10R	1 1/4	56.0	15.0	30.0	60.0	77 OCT	54.0	G45
C3UO-12R	1 1/2	63.0	18.0	36.0	72.0	80 OCT	63.0	G50
C3UO-16R	2	76.0	18.0	36.0	72.0	95 OCT	77.0	G65

Socket Weld Union O-ring Type

CUO-SW

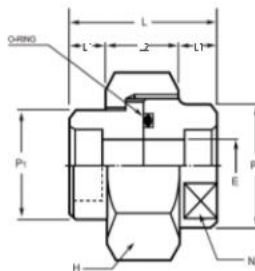

3000 lb

PART No	SW	P1	P2	E	L1	L2	L	N	H	O-ring
C3UO-02SW	1/4	22.0	24.0	10.0	10.0	18.0	38.0	21.0	35 HEX	P18
C3UO-03SW	3/8	27.0	30.0	12.0	10.0	18.0	38.0	26.0	41 HEX	P20
C3UO-04SW	1/2	32.0	35.0	16.0	10.0	12.0	44.0	32.0	46 HEX	G25
C3UO-06SW	3/4	38.0	42.0	20.0	12.0	26.0	50.0	38.0	54 HEX	G30
C3UO-08SW	1	47.0	52.0	25.0	15.0	26.0	56.0	46.0	63 HEX	G35
C3UO-10SW	1 1/4	56.0	60.0	32.0	15.0	30.0	60.0	54.0	77 HEX	G45
C3UO-12SW	1 1/2	63.0	68.0	38.0	18.0	36.0	72.0	63.0	80 OCT	G50
C3UO-16SW	2	76.0	82.0	48.0	17.0	18.0	36.0	72.0	95 OCT	G65

All dimensions are in millimeters unless otherwise specified and only for reference subject to change. www.dklok.com

Brisbane Sydney Melbourne Darwin Perth
 VALVE AND FLOW CONTROL SPECIALISTS PTY LTD
 E-mail sales@valveandflowcontrolspecialists.com