



VALVE AND FLOW CONTROL SPECIALISTS
SERVICE AND RELIABILITY

BIMETALLIC STEAM TRAPS AND AIR ELIMINATORS
FIG No. BSS 20

DESCRIPTION

BSS 20 all stainless steel construction steam traps and air eliminators are simple and robust traps, specially suited for instrument tracing, line tracing applications and where condensate sensible heat can be recovered.

Specially recommended as air eliminator.

Consider pairing with the VB 21 vacuum breaker.

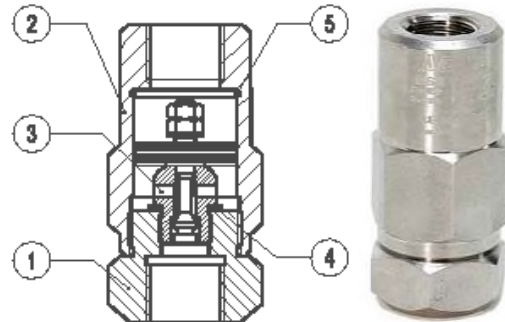

MAIN FEATURES

- Modulating discharge.
- Discharges condensate below steam temperature.
- Excellent air discharge.
- Operates on superheated steam.
- Unaffected by water hammer and vibrations.
- Inner valve performing as a check valve.
- Built-in strainer.

MATERIALS:

Part No.	DESIGNATION	MATERIAL
1	BODY	AISI 304
2	COVER	AISI 304
3	* VALVE ASSY.	SPECIAL ST. STEEL
4	* GASKET	AISI 304
5	* STRAINER SCREEN	AISI 304

* AVAILABLE SPARE PARTS

USE: Saturated and superheated steam.

SIZES: 1/2"

CONNECTIONS: Female screwed ISO 7/1Rp(BS21)
ANSI B2.1 NPT

INSTALLATION: Horizontal or vertical installation.

CE – PN40

Max. allowable pressure 34.4 bar

Related temperature 100 °C

Max allowable pressure 20 bar

Related temperature 250 °C

How to order: i.e. BSS20 DN 1/2" BSP.

DIMENSIONS (mm)

SIZE	A	B	C	WEIGHT
DN				Kg
1/2"	80	35	36	0,42

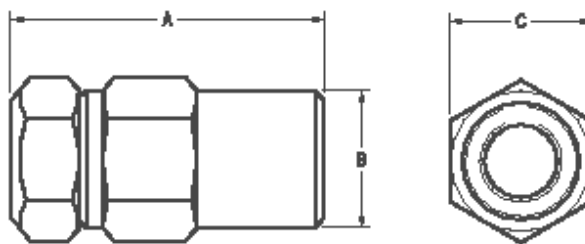

A=Condensate discharge at 10 Deg C below saturation temperature

B= Cold water capacity 20 Deg C

		FLOW RATE CAPACITY IN Kg/h														
		DIFFERENTIAL PRESSURE (bar)														
MODEL	SIZE	0.6	0.8	1	1,5	2	3	4	5	6	7	8	10	13	15	20
BSS20	1/2" A	45	60	65	85	100	130	155	170	195	205	220	245	255	270	330
BSS20	1/2" B	150	195	230	285	350	440	490	540	630	650	680	730	820	980	1120

VALVE AND FLOW CONTROL SPECIALISTS

Brisbane Sydney Melbourne Perth Darwin

E-mail sales@valveandflowcontrolspecialists.com