

SERIES 560/570 SAFETY VALVES

Our 560 / 570 valve line is a high capacity safety valve used for boilers, piping lines and vessel protection. Designed and engineered for heavy-duty industrial use. ASME and National Board Certified for Section I and XIII "UV" for ASME Section VIII Div. 1 service as well as CE and CRN Certifications.

**SERIES
560**



SERIES 560

Use for ASME Section I applications, .
Boilers, or most areas where steam safety valves are required.
Set pressure up to 250 psig (17.2 barg)

SERIES 563

Same as Series 560 except with Stainless Steel wetted trimming (Nozzle and Disc),
Set pressure up to 300 psig (20.7 barg)

SERIES 570

ASME Section XIII "UV" for Section VIII Div. 1, CE, CRN certified for unfired vessel protection.
Used for many applications to protect or relieve pressure for Air / Gas or Steam.
Set pressures: Air up to 300 psig (20.7 barg), Steam to 250 psig (17.2 barg).

SERIES 573

Same as Series 570 except with Stainless Steel wetted trimming (Nozzle and Disc),
Set pressure for air and steam up to 300 psig (20.7 barg)

**SERIES
573**



Usages: Steam Boilers, Air Compressors, Dryers, Receivers, Pressure Vessels, Piping Systems, Accumulators, Reducing Stations, Tanks, Inter/After Coolers, Cooking Equipment, Autoclaves, Sterilizers or wherever higher capacity pressure protection or relief may be required.

Features:

- Designed for durability
- 6 orifices – 12 sizes of piping options
- Top guided seating and discharge
- Full nozzle, high capacity levels
- Short, tuned blow-down with dual-ring technology
- Heavy duty hood and lever mechanism
- Standard 17-7 stainless steel springs

Options:

- O-ring seating options (see charts)
- Packed lift lever
- Stainless steel trimming package, nozzle, disc (all sizes)
- Bubble tight seating options
- Anti-vibration spring for lift lever
- BSPT and BSPP pipe threading
- Tri-Clamp Inlets
- O2 Cleaning



Brisbane Sydney Melbourne Darwin
VALVE AND FLOW CONTROL SPECIALISTS PTY LTD

E-mail sales@valveandflowcontrolspecialists.com

SEATING OPTIONS

SEATING MATERIALS

MATERIAL	NAMES	MIN TEMP °F (°C)	MAX TEMP °F (°C)	USE FOR:
FKM	Viton-A	-13° (-25°)	446° (230°)	Acetone, Air, Alcohol, Benzine, Butane, Ethylene, Ethylene Glycol, Ethyl Alcohol, Gasoline, Isobutyl Alcohol, Kerosene, Lube Oil, Natural Gas, Naphtha, Nitrogen, Propane, Water, Xylene
Nitrile	Buna-N	-40° (-40°)	250° (121°)	Air, Butane, Carbon Dioxide, Diesel Oil, Ethyl Chloride, Ethyl Ether, Fuel Oil, Gasoline, Helium, Hydrogen Sulphide, Kerosene, Natural Gas, Nitrogen, Oxygen (Gas), Propane
EPDM		-40° (-40°)	303° (151°)	Steam (under 55 psig), Water, Hot Water, Acetone, Beer, Brake Fluid, Hydrogen Gas, Sulfur Dioxide, Acids, Alkalies
FFKM	Markez®	5° (-15°)	500° (260°)	Aromatic Hydrocarbons, Chlorinated Hydrocarbons, Polar Solvents (ketones, esters, ethers), Inorganic and Organic Acids, Water, and Steam.
	Kalrez®	-10° (-23°)	550° (288°)	
PTFE		-450° (-268°)	500° (260°)	Cryogenic Service including Argon, Carbon Dioxide, Helium, Hydrogen, Nitrogen, Oxygen, Steam

Note:
This is just a partial listing.

SOFT SEAT OPTION

ITEM	DESCRIPTION	560 / 570	563 / 573
22	Disc	B16 Brass	A479-316 SS
23	O-Ring	Various	Various
24	Center Insert	B16 Brass	A479-316 SS
25	Screw	18-8 SS	18-8 SS

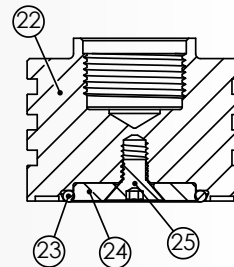

Soft Seat Option



SERIES 560-563-570-573 PART NUMBERS

573		DC	1	M	1	L	1	250
SERIES/DESCRIPTION	ORIFICE/SIZE ID	CONNECTION	SEATING	CAP	SERVICE	OPTIONS	SET	
560- Brass/bronze Section I	DC- 1/2" x 3/4"	1- NPT MxF	M- Metal	1- Lift lever	K- ASME XIII "UV"- Air/gas	1- None	Ex. 250	
	DD- 3/4" x 3/4"	2- NPT FxF	P- PTFE	3- Packed lift lever	L- ASME XIII "UV"- Steam	2- Chrome Plating		
563- 316 SS/Bronze Section I	DE- 1/2" x 1"	3- BSPT MxF	E- EPDM	4- Lift Lever with Anti Vibe Spring	A- ASME I Steam	3- O2 Cleaned		
	DF- 3/4" x 1"	4- BSPT FxF	V- Viton	6- Packed Lever with Test Gag	P- CE - Air/gas	4- API Seating		
570- Brass/bronze Section VIII	DH- 1" x 3/4"	5- Tri-Clamp x NPT	B- Buna		9- Easy Test Lever	E- CE - Steam		5- O2 Clean / API Seating
	DJ- 1-1/2" x 3/4"	6- Tri-Clamp x BSPT	K- Kalrez	N- Non-code Air/gas		6- O2 Clean / Chrome		
573- 316 SS/bronze Section VIII	ED- 3/4" x 1"	8- BSPP MxF	Z- Markez	A- Open Lever with Test Gag	T- Non-code Steam	7- O2 / API / Chrome		
	EE- 1" x 1"	9- BSPP FxF			8- API/Chrome			
	EJ- 1-1/2" x 1"							
	FE- 1" x 1-1/4"							
	FF- 1-1/4" x 1-1/4"							
	FG- 1-1/2" x 1-1/4"							
	GF- 1-1/4" x 1-1/2"							
	GG- 1-1/2" x 1-1/2"							
	HG- 1-1/2" x 2"							
	HH- 2" x 2"							
JH- 2" x 2-1/2"								
JJ- 2-1/2" x 2-1/2"								

Note:
Tri-Clamp connections are Series 563 / 573 Only.
1/2" and 1-1/4" inlet not available in Tri-Clamp.
Sizes DH - DJ - EJ - FG are Tri-Clamp only.

• Safety Relief Valves

Brisbane Sydney Melbourne Darwin

VALVE AND FLOW CONTROL SPECIALISTS PTY LTD

E-mail sales@valveandflowcontrolspecialists.com

DIMENSIONS AND MATERIALS

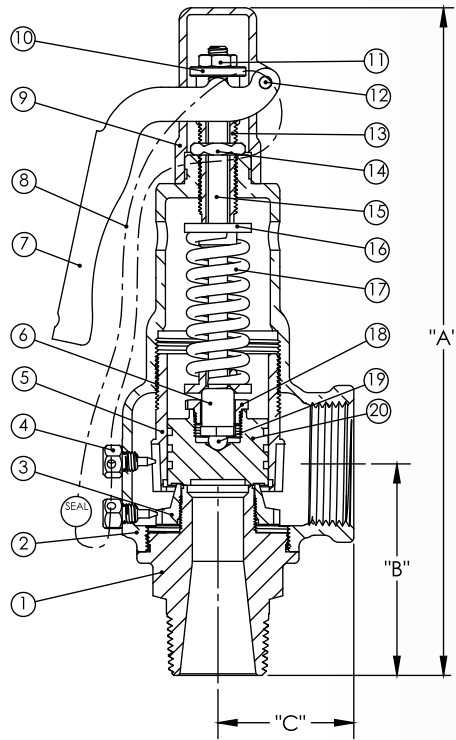

SERIES 560 / 570 / 563 / 573			
ITEM	DESCRIPTION	560 / 570	563 / 573
1	Body	B16/B62-C83600	SA479-316 SS
2	Bonnet	B584-C84400	B584-C84400
3	Lower Ring	B584-C84400	B584-C84400
4	Lock Screw	B16 Brass	B16 Brass
5	Upper Ring	B584-C84400	B584-C84400
6	Spring Support	B16 Brass	B16 Brass
7	Lift Lever	Steel / Plated	Steel / Plated
8	Seal Wire	Steel / Galvanized	Steel / Galvanized
9	Hood	Aluminum / Plated	Aluminum / Plated
10	Lifter Nut	B16 Brass	B16 Brass
11	Jam Nut	18-8 SS	18-8 SS
12	Lever Pin	B16 Brass	B16 Brass
13	Pressure Screw	B16 Brass	B16 Brass
14	Lock Nut	B16 Brass	B16 Brass
15	Stem	B16 Brass	B16 Brass
16	Spring Plate	B16 Brass	B16 Brass
17	Spring	302/17-7 SS	302/17-7 SS
18	Disc Nut	B16 Brass	B16 Brass
19	Ball Bearing	440 SS	440 SS
20	Disc	B16 Brass	SA479-316 SS
21	Name Plate	Stainless	Stainless

SERIES 560-563-570-573									
ORIFICE	FLOW AREA In ² (mm ²)	INLET	OUTLET	DN	SIZE ID	DIMENSIONS – in (mm)			WEIGHT Lbs. (Kg)
						A	B	C	
D	.125 (80.6)	1/2"	3/4"	15	C	7-1/4" (184)	2-1/2" (64)	1-1/2" (38)	2.5 (1.1)
D	.125 (80.6)	3/4"	3/4"	20	D	7-1/4" (184)	2-1/2" (64)	1-1/2" (38)	2.5 (1.1)
E	.221 (142.6)	3/4"	1"	20	D	7-5/8" (194)	2-1/2" (64)	1-5/8" (41)	3 (1.4)
E	.221 (142.6)	1"	1"	25	E	7-5/8" (194)	2-1/2" (64)	1-5/8" (41)	3 (1.4)
F	.352 (227.1)	1"	1-1/4"	25	E	8-7/8" (225)	2-7/8" (73)	1-3/4" (44)	4 (1.8)
F	.352 (227.1)	1-1/4"	1-1/4"	32	F	8-7/8" (225)	2-7/8" (73)	1-3/4" (44)	4 (1.8)
G	.567 (365.8)	1-1/4"	1-1/2"	32	F	9-1/2" (241)	3-1/4" (83)	2-1/4" (57)	6 (2.7)
G	.567 (365.8)	1-1/2"	1-1/2"	40	G	9-1/2" (241)	3-1/4" (83)	2-1/4" (57)	6 (2.7)
H	.899 (580.0)	1-1/2"	2"	40	G	11" (279)	3-5/8" (92)	2-1/2" (64)	10 (4.5)
H	.899 (580.0)	2"	2"	50	H	11" (279)	3-5/8" (92)	2-1/2" (64)	10 (4.5)
J	1.463 (943.9)	2"	2-1/2"	50	H	12-5/8" (321)	4" (102)	3-1/8" (79)	15 (6.8)
J	1.463 (943.9)	2-1/2"	2-1/2"	65	J	12-5/8" (321)	4" (102)	3-1/8" (79)	15 (6.8)

SERIES	METALS	MIN. TEMP °F (°C)	MAX. TEMP °F (°C)	MAX PRESSURE psig (barg)	SERVICES	CERTIFICATIONS
560	Brass/Bronze	-20° (-29°)	406° (208°)	250 (17.2)	Steam	ASME I, CE, CRN
563	Stainless/Bronze	-20° (-29°)	425° (218°)	300 (20.7)	Steam	ASME I, CE, CRN
570	Brass/Bronze	-20° (-29°)	406° (208°)	250 (17.2)	Air / Gas / Steam	ASME XIII "UV", CE, CRN
573	Stainless/Bronze	-20° (-29°)	425° (218°)	300 (20.7)	Air / Gas / Steam	ASME XIII "UV", CE, CRN

Brisbane Sydney Melbourne Darwin
VALVE AND FLOW CONTROL SPECIALISTS PTY LTD
 E-mail sales@valveandflowcontrolspecialists.com