



VALVE AND FLOW CONTROL SPECIALISTS
SERVICE AND RELIABILITY

REFLEX GLASS LEVEL INDICATORS
DN 20 connection for pressures up to 40 Bar
From 310mm to 2115mm length centres

FIGURE NO. RGLI-11

- End Type:** DN20
- Material:** Body A105 GG25 valves Borosilicate glass
- Max Op Temp:** 250 Deg C
- Connections:** PN16 or PN40 flanged

The Reflex Glass Level Indicators work on the principle that water and vapour (steam) are seen in different brightnesses on the reflex glass, as a result of the different refraction of light in liquid and gas phases.

The liquid fluid appears quite dark due to the absorption of light, and the vapor appears bright because it reflects the light again.

- Applications:**
- All steam boilers - Filling and unloading containers
 - Fuel containers - Chemical industry
 - Tanks used for oil and petroleum products

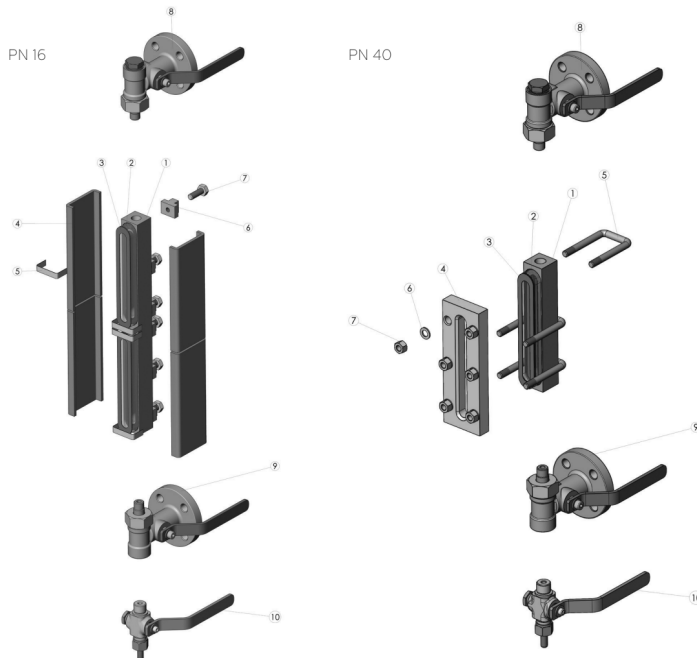

| NO | PN16 | MATERIAL |
|-----|---------------------|---------------|
| 1 | Body | A 105 |
| 2 | Indicator Glass | Borosilicate |
| 3 | Body - Cover Gasket | Pure Graphite |
| 4+5 | Cover | St37 |
| 6 | Seat | A 105 |
| 7 | AKV Bolt | 8.08 CK35 |
| 8+9 | Valve Unit | GG25 |
| 10 | Discharge Unit | GG25 |

| NO | PN40 | MATERIAL |
|-----|---------------------|--------------------|
| 1 | Body | A 105 |
| 2 | Indicator Glass | Borosilicate |
| 3 | Body - Cover Gasket | Pure Graphite |
| 4 | Cover | A 105 |
| 5 | Cover Tighten Part | Transmission Steel |
| 6 | Nut | M 108 |
| 7 | Gasket | St37 |
| 8+9 | Valve Unit | GG25 |
| 10 | Discharge Unit | GG25 |



VALVE AND FLOW CONTROL SPECIALISTS
SERVICE AND RELIABILITY

TECHNICAL DIMENSIONS

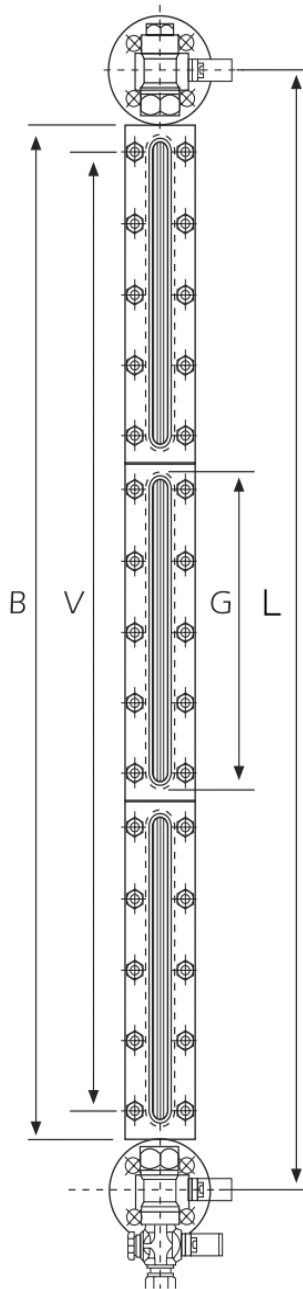

| DIMENSIONS (mm) | | | | |
|-----------------|------|------|------|-----|
| No | L | B | V | G |
| 1 | 310 | 205 | 168 | 190 |
| 2 | 340 | 235 | 198 | 220 |
| 3 | 370 | 265 | 228 | 250 |
| 4 | 400 | 295 | 258 | 280 |
| 5 | 440 | 335 | 298 | 320 |
| 6 | 515 | 410 | 373 | 190 |
| 7 | 575 | 470 | 433 | 220 |
| 8 | 635 | 530 | 493 | 250 |
| 9 | 695 | 590 | 553 | 280 |
| 10 | 775 | 670 | 633 | 320 |
| 11 | 900 | 795 | 758 | 250 |
| 12 | 990 | 885 | 848 | 280 |
| 13 | 1110 | 1005 | 968 | 320 |
| 14 | 1285 | 1180 | 1143 | 280 |
| 15 | 1445 | 1340 | 1303 | 320 |
| 16 | 1580 | 1475 | 1438 | 280 |
| 17 | 1780 | 1675 | 1638 | 320 |
| 18 | 2115 | 1973 | 1973 | 320 |

Uncontrolled document subject to change without notice

VALVE AND FLOW CONTROL SPECIALISTS

Brisbane Sydney Melbourne Darwin

E-mail sales@valveandflowcontrolspecialists.com