



VALVE AND FLOW CONTROL SPECIALISTS
SERVICE AND RELIABILITY

Y Strainer Cast Steel Flanged ASA 300
FIGURE NO. VYS-C304

End Type : ANSI 300 RF Flanged
Materials : WCB cast Steel Body 316 stainless screen
Size Range: 15nb to 300nb

- * Bolted cap with plug for blowdown
- * F-F per ANSI B16.10
- * Flange ANSI B16.5
- * Design ANSI B16.34
- * Test to API 598
- * **Also available in drilled ASA 150, DIN 16 and DIN40**

VCS OPTIONS :

- * Blowdown Valve.

| SIZE | L | D | D1 | D2 | Z - d | T | f |
|------|-----|-------|-------|------|----------|------|---|
| 15 | 152 | 95 | 66.5 | 35 | 4 - 16 | 14 | 2 |
| 20 | 178 | 117.5 | 82.5 | 43 | 4 - 19 | 16 | 2 |
| 25 | 203 | 124 | 89 | 51 | 4 - 19 | 17.5 | 2 |
| 32 | 216 | 133.5 | 98.5 | 63.5 | 4 - 19 | 19 | 2 |
| 40 | 229 | 155.5 | 114.5 | 73 | 4 - 22.5 | 20.5 | 2 |

VCS standard Drain plug / blowdown facility
DN15 to DN 40 is 1/4" BSPT
DN 50 to DN100 is 1/2" BSPT
DN 125 to DN300 is 3/4" BSPT

| SIZE | L | D | D1 | D2 | B | H | Z - d |
|------|-----|-----|-------|-----|------|-----|-----------|
| 50 | 267 | 165 | 127 | 92 | 22.7 | 205 | 8 - 19 |
| 65 | 292 | 190 | 149.2 | 105 | 25.9 | 225 | 8 - 22 |
| 80 | 318 | 210 | 168.3 | 127 | 29 | 245 | 8 - 22 |
| 100 | 356 | 255 | 200 | 157 | 32.2 | 310 | 8 - 22 |
| 125 | 400 | 280 | 235 | 186 | 35.4 | 390 | 8 - 22 |
| 150 | 444 | 320 | 270 | 216 | 37 | 430 | 12 - 22 |
| 200 | 559 | 380 | 330.2 | 270 | 41.7 | 550 | 12 - 25 |
| 250 | 622 | 445 | 387.4 | 324 | 48.1 | 706 | 16 - 28.5 |
| 300 | 711 | 520 | 450.8 | 381 | 51.3 | 832 | 16 - 32 |

| PART NAME | MATERIAL |
|--------------|------------------|
| TAPERED PLUG | ASTM A105 |
| BOLT | ASTM A193 B7 |
| NUT | ASTM A194 2H |
| BONNET | ASTM A216 WCB |
| GASKET | SS304 + GRAPHITE |
| STRAINER | ASTM A276 316 |
| BODY | ASTM A216 WCB |

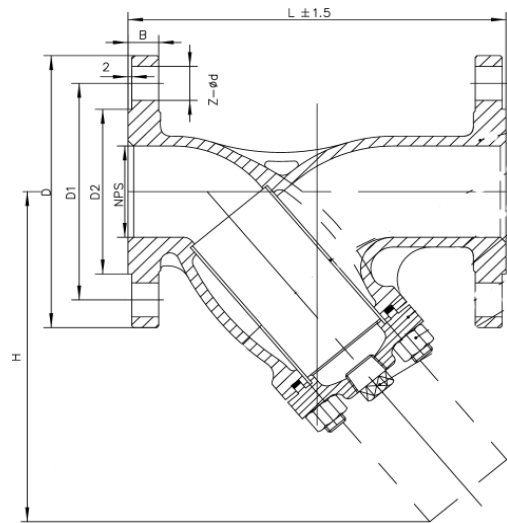

Screen mesh is SUS 316 SS material with perforation 1.0mm to 1.6mm
Mesh interlining options of 60 and 100 mesh.

Note WCB cast steel temperature limitation is 425 Deg C

General arrangement drawing subject to change without notice, Doc ref VCS20230402