

## MK7C/1000 Steam Trap with Integral Strainer

The Australian Made High Capacity Clam Disc Traps are utilized where higher pressures and temperatures are incurred whilst offering quick repairability and turnaround times which is a necessity in critical services.



**Condensate capacity:** Varies according to insert.  
**Valve and seat inserts:** G3 and J3, for  
**Selection:** See capacity charts.  
**Pressure limits:** 3100-10340 kPa.  
**Temperature limits:** To 566°C with G3 or J3 fitted.

**NOTE:** Dimension 'A' includes raised-faces

### SCREWED

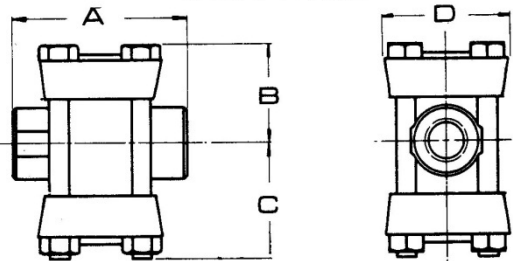

BSPT – NPT – BUTT or SOCKET WELD

#### DIMENSIONS mm

SIZE	15	20	25
A	114	114	114
B	89	89	89
C	89	89	89
D	89	89	89

### FLANGED

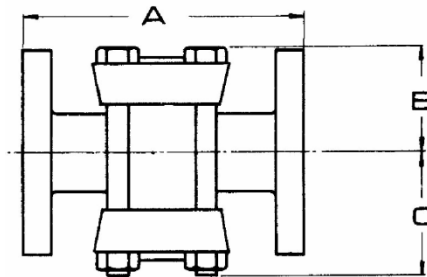

#### DIMENSIONS mm — ANSI 600

SIZE	15	20	25
A	197	197	197
B	89	89	89
C	89	89	89

#### DIMENSIONS mm — ANSI 1500

SIZE	15	20	25
A	216	216	216
B	89	89	89
C	89	89	89

ITEM	DESCRIPTION	MATERIAL	PART NO.
1	BODY	CHROME MOLY STEEL ASTM A182 Gr. F11 FORGING	B7C1000/FS
2	TRAP COVER		C7C1000/S
3	STRAINER COVER	STAINLESS STEEL TYPE 154CM	SC7C1000/S
4	SEAT		G3, J3
5	VALVE ONLY	304 STAINLESS STEEL	SE1
6	STRAINER ELEMENT		
7	INNER BODY GASKET	"METAFLEX" 316 S/S SPIRAL WOUND and GRAPHITE FILLED.	G48
8	OUTER BODY GASKET		G14
9	COVER GASKET		G15
10	STRAINER GASKET		G15
11	BOLTS & NUTS	ASTM 193 Gr. B16 STUDS 5/8"unc & ASTM A194 Gr. 4 NUTS	HD12